

DRYWALL REVEAL

TRIM PURPOSE

- Creates an aesthetic division between drywall panels on vertical walls and ceilings
- Used to create horizontal or vertical lines and can intersect cleanly where desired

SPECIFICATIONS

- Standard extruded aluminum alloy 6063 T5
- Have a typical .050" nominal wall thickness or greater
- Come in 10 foot lengths
- Stocked as Clear Anodized and Mill Finish (for field painting or priming)
- Chem-film, other factory finishes and custom paint are available
- Can be bent into corners, intersections and radius (but will be considered a custom part)
- Certain sizes come with alignment splices to ease installation

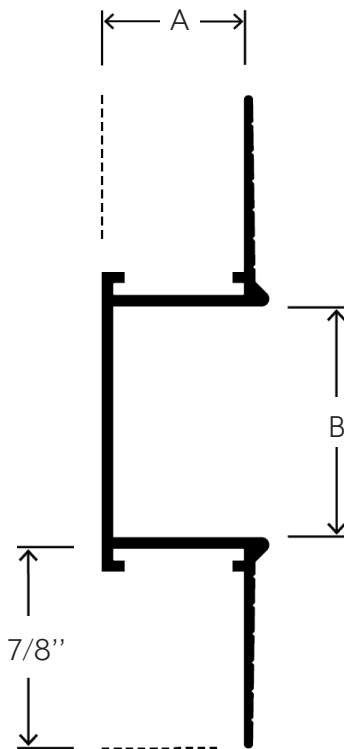
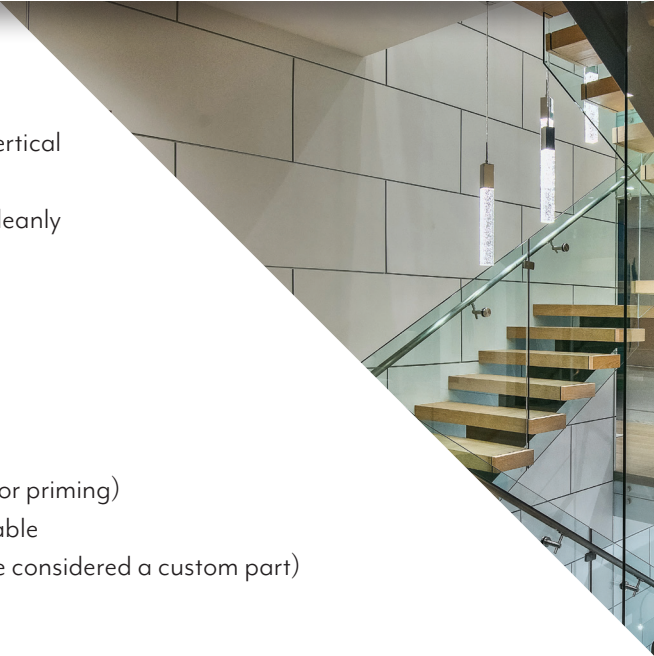

PART NO.	"A" DEPTH	"B" WIDTH
DWR 375-375	3/8"	3/8"
DWR 50-125	1/2"	1/8"
DWR 50-25	1/2"	1/4"
DWR 50-375	1/2"	3/8"
DWR 50-50	1/2"	1/2"
DWR 50-75	1/2"	3/4"
DWR 50-100	1/2"	1"
DWR 50-150	1/2"	1 1/2"
DWR 50-200	1/2"	2"

(Chart Continues on next page)

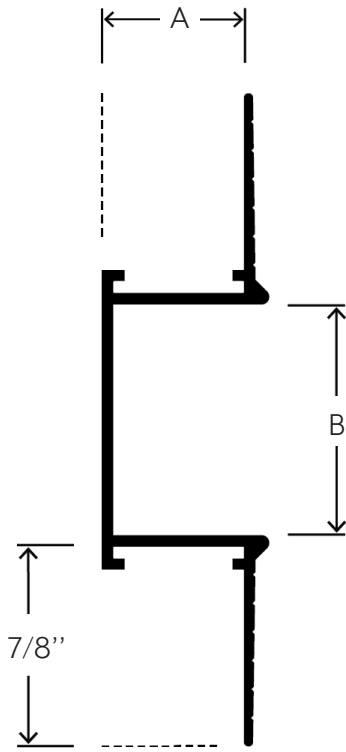

PART NO.	"A" DEPTH	"B" WIDTH
DWR 50-300	1/2"	3"
DWR 50-600	1/2"	6"
DWR 625-25	5/8"	1/4"
DWR 625-375	5/8"	3/8"
DWR 625-50	5/8"	1/2"
DWR 625-625	5/8"	5/8"
DWR 625-75	5/8"	3/4"
DWR 625-100	5/8"	1"
DWR 625-150	5/8"	1 1/2"
DWR 625-200	5/8"	2"
DWR 625-300	5/8"	3"
DWR 625-400	5/8"	4"

ALIGNMENT SPLICES AND END CAPS

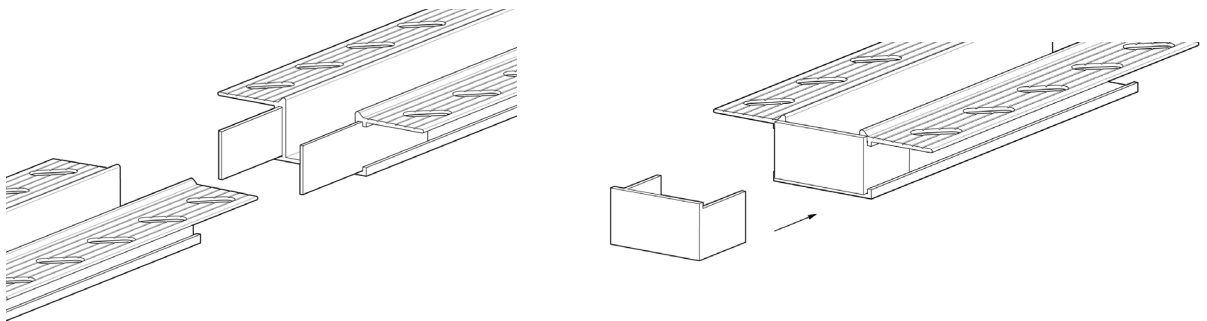

INSTALLATION DETAIL

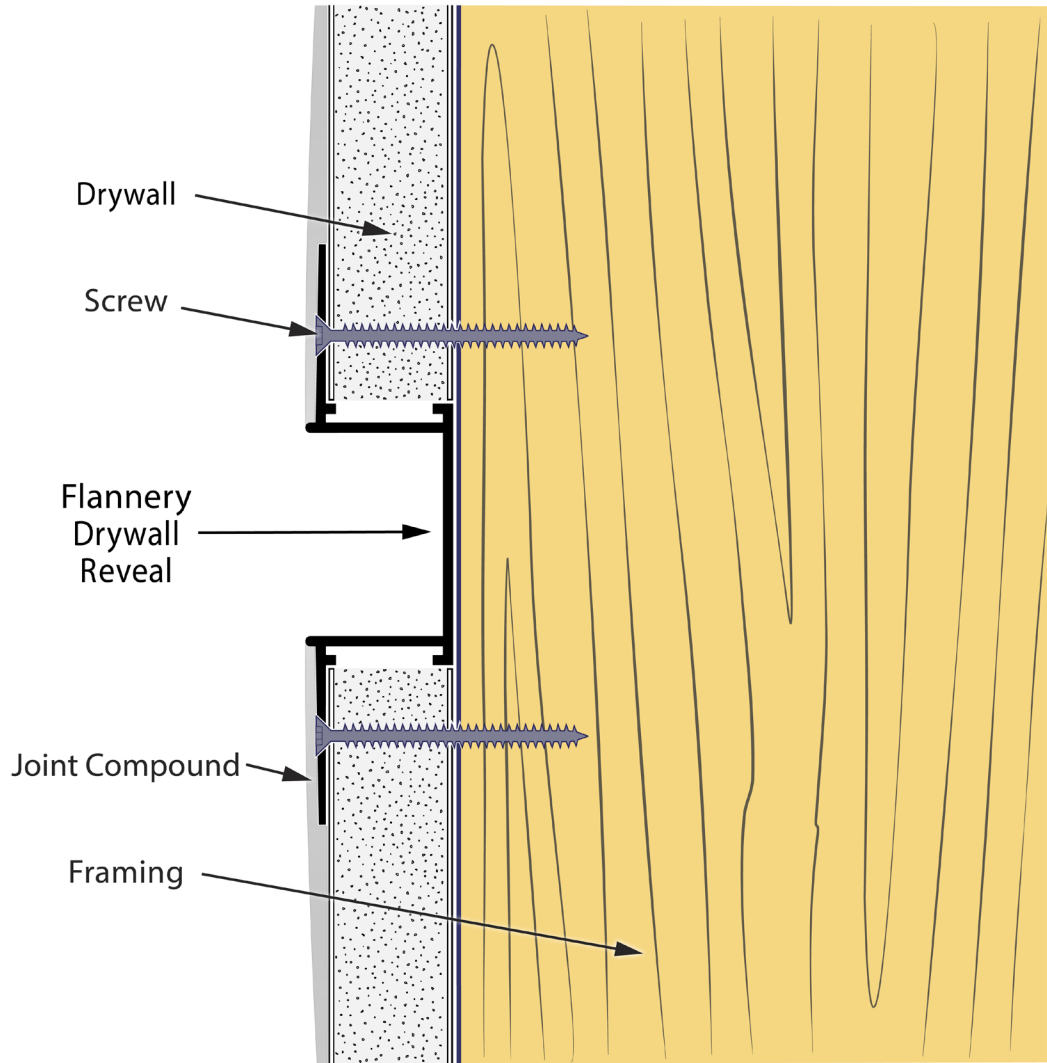

INSIDE AND OUTSIDE CORNERS AND INTERSECTIONS

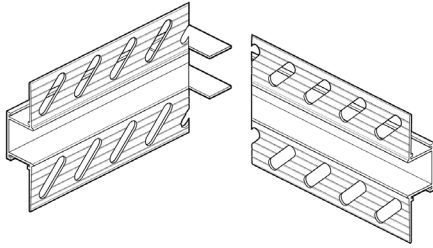

Inside Corner

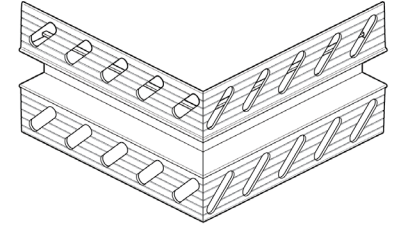

Outside Corner

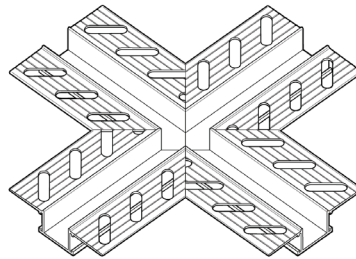

4-Way Intersection

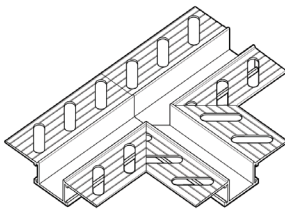

3-Way Tee Intersection

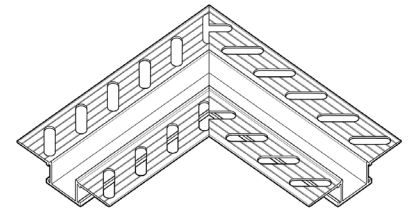

90 Degree Intersection

FACTORY BENT RADIUS

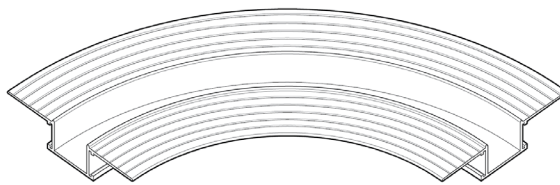

Curves - Inside/Outside

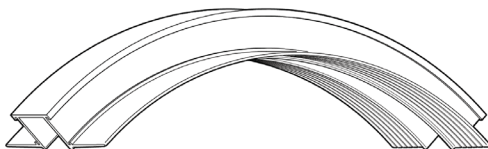

Arch

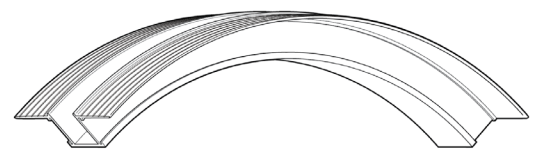

Reverse Arch