

# CHANNEL SCREED VENT

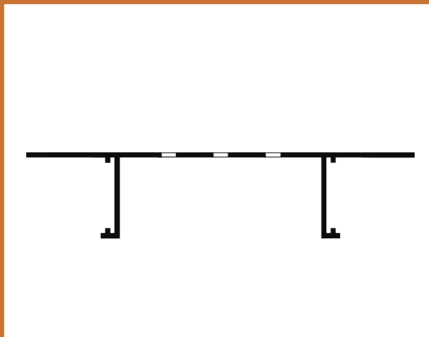

**PCS VENT**

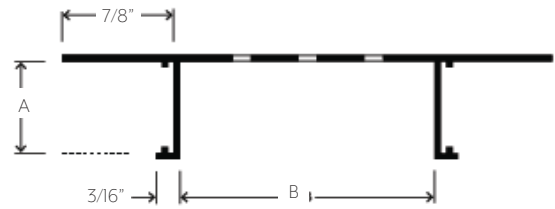

## APPLICATION

Flannery's Channel Screed Vent creates an aesthetic ventilation strip in a soffit area. Flannery's Channel Screed Vents come in a number of depths for different soffit material thicknesses as well as a number of reveal widths for just the right amount of ventilation.

## SPECIFICATION

- Standard extruded aluminum alloy 6063 T5
- Typical .050" nominal wall thickness or greater
- Come in 10-foot lengths
- Stocked in Clear Anodized and Mill Finish (for field painting and priming)
- Chem-film, other factory finishes and custom paint are available

PART NO.	"A" DEPTH	"B" WIDTH	VENT SLOTS PER ROW
PCS 375-V-50	3/8"	1/2"	1
PCS 375-V-75	3/8"	3/4"	1
PCS 375-V-100	3/8"	1"	1
PCS 375-V-150	3/8"	1 1/2"	2
PCS 50-V-50	1/2"	1/2"	1
PCS 50-V-75	1/2"	3/4"	1
PCS 50-V-100	1/2"	1"	1
PCS 50-V-150	1/2"	1 1/2"	2
PCS 50-V-200	1/2"	2"	3
PCS 50-V-250	1/2"	2 1/2"	3
PCS 50-V-300	1/2"	3"	5
PCS 50-V-400	1/2"	4"	7
PCS 50-V-600	1/2"	6"	9
PCS 625-V-50	5/8"	1/2"	1
PCS 625-V-75	5/8"	3/4"	1
PCS 625-V-100	5/8"	1"	1
PCS 625-V-150	5/8"	1 1/2"	2
PCS 625-V-200	5/8"	2"	3
PCS 625-V-300	5/8"	3"	5
PCS 625-V-400	5/8"	4"	7
PCS 75-V-75	3/4"	3/4"	1
PCS 75-V-100	3/4"	1"	1
PCS 75-V-150	3/4"	1 1/2"	2
PCS 75-V-200	3/4"	2"	3
PCS 75-V-250	3/4"	2 1/2"	3
PCS 75-V-300	3/4"	3"	5
PCS 75-V-400	3/4"	4"	7
PCS 75-V-600	3/4"	6"	9

# CHANNEL SCREED VENT

## INSTALLATION DETAIL

Attach Channel Screed Vents to the framing with nails, screws, or other approved fastening methods. Flannery's Aluminum Soffit Vents are also available with bug screen upon request. Select sizes of Flannery's Channel Screed Vents are available with Aluminum Alignment Splices to ease the installation process and create crisp clean butt joints.

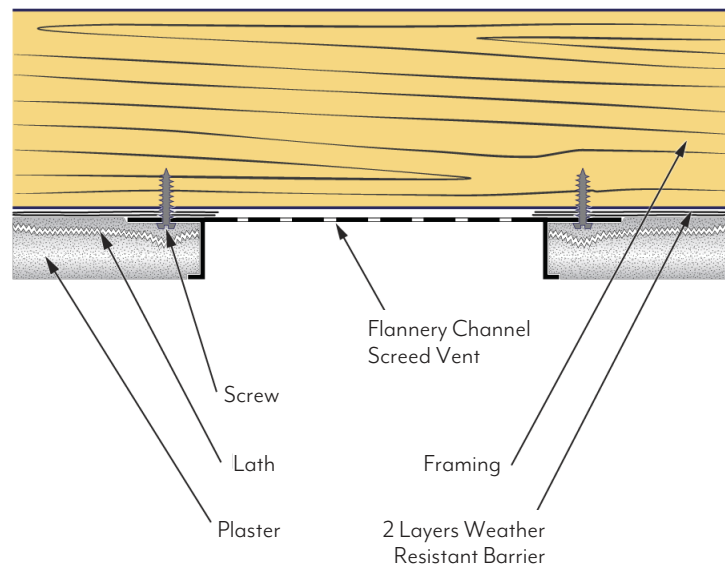

# SOFFIT VENTILATION SPECIFICATIONS

## VENT AREA GRAPH

REVEAL WIDTH	VENT SLOTS PER ROW	VENT AREA PER FOOT
1/2"	1	1" Sq.
5/8"	1	1" Sq.
3/4"	1	1" Sq.
7/8"	1	1" Sq.
1"	1	1" Sq.
1 1/2"	2	2" Sq.
2"	3	3" Sq.
2 1/2"	3	3" Sq.
3"	5	5" Sq.
4"	7	7" Sq.
6"	9	9" Sq.

It is possible to punch Vent Slots into many of Flannery's Trims, thus providing the needed ventilation for any project. All Vent Slots are 1/8" wide and 1" long. Vent Slots are configured at 1/2" on center lengthwise and 1/2" on center laterally. Each row of Vent Slots lengthwise provides approximately one-square inch of vented area per lineal foot (see Vent Area Graph). All of Flannery's Vented Trims are available with a charcoal fiberglass bug screen to prevent insects from entering the soffit area through the vent slots. Bug screen is available upon request at an additional cost.

Flannery manufactures ventilated trims for a number of soffit systems including, Plaster, EIFS, Exterior Gypsum Board and Wood Paneling. Attach Vent Screeds to the framing with nails, screws, or other approved fastening methods. All Vent Screeds must be cut accurately and installed with tight, neat joints. Please specify Flannery Product Code along with the phrase "with Vent" (i.e. "PCS 75-V-200 with Vent") when ordering Vent Screeds.

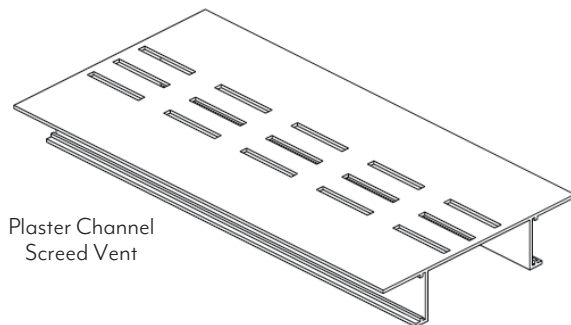

Plaster Channel  
Screed Vent

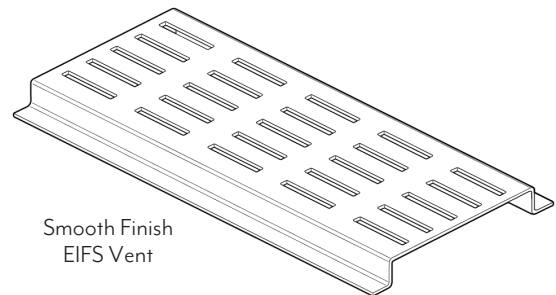

Smooth Finish  
EIFS Vent

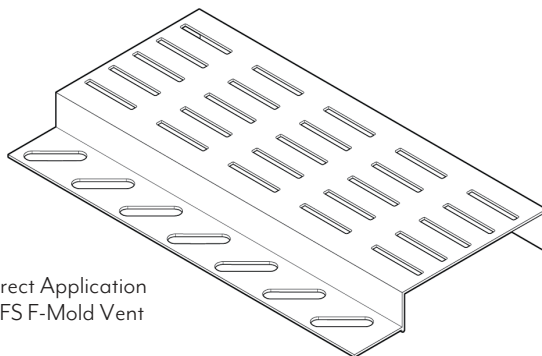

Direct Application  
EIFS F-Mold Vent

# GENERAL SPECIFICATIONS FOR FLANNERY TRIM

## PRODUCT SPECIFICATIONS

Flannery recommends that any installer of our Aluminum Trims properly layout and coordinate the installation of trims along with materials that will be utilized in the installation of the exterior wall system.

## FLANNERY ALUMINUM TRIM ALLOY & COMPOSITION

Flannery's Aluminum Trims are standard extruded aluminum alloy 6063 T5 and have a typical .050" or greater nominal wall thickness. Extruded Aluminum Trims are aesthetic trims which are not intended to hold or support the full weight of any Panel, Stucco, or Plaster system. Flannery's Trims meet or exceed ASTM B221 for extruded aluminum products.

Flannery's Aluminum Trims come in 10' lengths typically and shall have a standard stock finish of Mill Finish (for field priming & painting) or Clear Anodized (some may be stocked in Black Anodized). Other factory finishes including liquid or powder coated paint, Chem-Film, Primer and special Anodizing finishes are available. All of our other finishing options can be viewed on the next page.

## HANDLING ALUMINUM TRIMS

Personal protection equipment should be utilized when handling and installing aluminum trims. Gloves and eye protection must be worn when handling aluminum trims as well as ear protection when cutting.

## CUTTING ALUMINUM MOLDINGS

Flannery recommends that ten-foot lengths be used wherever possible. Aluminum Moldings can be cut with a chop saw, using a 125-150-tooth carbide-tip blade for non-ferrous metal. An abrasive cut-off wheel should not be used to cut aluminum trims. Blade lubricant (WD-40 or grease stick) must be applied to the blade before each cut. Lubricant should be cleaned from the trim prior to installation.

## STEPS FOR FIELD PAINTING MILL FINISH (RAW) ALUMINUM MOLDINGS

1. Clean and treat moldings in accordance with the paint manufacturer's specifications.
2. Use a primer recommended by the paint manufacturer's specifications.
3. Apply the paint coat according to the paint manufacturer's specifications.
4. Flannery makes no guarantees, nor accepts any responsibility, for the performance of field-applied coatings over anodized finishes.
5. If aluminum trim has an alternate finish, contact Flannery for field painting instructions.

## PLEASE NOTE

*This product sheet presents general guidelines and suggestions for the installation of Flannery trims and products. The purpose of these general guidelines and suggestions is to aid in a successful interior or exterior finish based on the Uniform Building Code and industry standards. No one catalog or product guide can address all of the unique specifics or installation details that occur from one project to another. Flannery recommends that every installer be familiar, or become acquainted with, common interior or exterior trim installation practices before installing any of Flannery's many trims and products. Flannery also recommends that the specifying architect, engineer, and general contractor be consulted with as well.*