



Flannery, Inc
Specialty Aluminum Trims

PANEL TRIMS

FIBER CEMENT, MILLWORK AND COMPOSITE SIDING

flannerytrim.com - 818.837.7585

TABLE OF CONTENTS

OUR STORY _____	02	PANEL EDGE CAP _____	24
PRODUCT OVERVIEW _____	03	PANEL BASE MOLD _____	25
SHAPEFINDER _____	04	STARTER J-STRIP _____	26
VERTICAL REVEALS _____	07	STARTER J-VENT _____	27
PANEL SCREED _____	08	DOOR & WINDOW TRIMS _____	29
PANEL H-MOLD _____	09	PANEL DRIP CAP _____	30
PANEL H-CAP _____	10	SIDING WINDOW RETURN _____	31
PANEL SNAP-IN SCREED _____	11	OUTSIDE CORNERS _____	33
OFFSET PANEL SCREED _____	12	PANEL X CORNER MOLD _____	34
HORIZONTAL REVEALS _____	15	PANEL OUTSIDE CORNER _____	35
PANEL Z-FLASH _____	16	INSIDE CORNERS _____	37
HORIZONTAL PANEL REVEAL _____	17	PANEL INSIDE CORNER REVEAL _____	38
PANEL T-PIECE _____	18	PANEL INSIDE CORNER W-MOLD _____	39
TERMINATION TRIMS _____	21	FURRING STRIPS _____	41
PANEL J-MOLD _____	22	FURRING STRIP _____	42
PANEL F-MOLD _____	23	Z-FUR STRIP _____	43
		INSTALLATION DETAILS _____	44



OUR STORY

Since 1975, **Flannery Inc.** has been the premier manufacturer of aluminum and steel trims. Family-owned and based in San Fernando, California, we have manufactured a range of trim products— fabricated solely in the United States— that are designed to complement both interior and exterior wall systems. We have grown from producing trims for drywall and stucco to a full line of panel and ceiling trims. Our full production and fabrication facility boasts one of the largest product inventories of niche extruded aluminum construction trims. We are dedicated to providing more than the necessary technical assistance and customer service that will enable any builder, architect, or owner to succeed in their building design.



PRODUCT OVERVIEW

Enclosed in this brochure, you will find a variety of practical and decorative trim products specifically designed for the many types of paneling on the market today. While you may see an emphasis on exterior applications, all the trims in this brochure are extruded aluminum products which makes them usable for all sorts of installation and design possibilities.

Our Panel Trim products are suitable for three different types of wall systems and can be used in an interior or exterior application. The trims that follow can be utilized with Fiber Cement, Composite Siding, and Millwork Panel projects. Most of the installation details that we present in this brochure will be for an exterior wall application, but all of these products can also be used on the inside of a building and can be integrated into a millwork or wood paneling system. Installation details for an interior application can be viewed on our website at flannerytrim.com under Interior Trim.

When reviewing Flannery's Panel Trims, please keep in mind that our product codes will indicate the trim's primary design purpose, however, it may be used in alternate systems. The first letter in the product code typically represents the type of system the product was built for.

"C" indicates a Cement Panel product (i.e. CPS 375-50, CPX 375-375, etc.).
"S" indicates a composite Siding product (i.e. SJM 625-100, SIC 875-100, etc.).
"W" indicates a Wood Panel or Millwork product (i.e. WPR 75-375, WPH 75-375, etc.).

SHAPEFINDER

- VERTICAL REVEALS
- HORIZONTAL REVEALS
- TERMINATION TRIMS
- DOOR & WINDOW TRIMS
- OUTSIDE CORNERS
- INSIDE CORNERS
- FURRING STRIPS

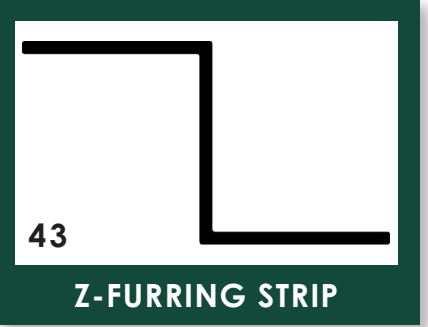
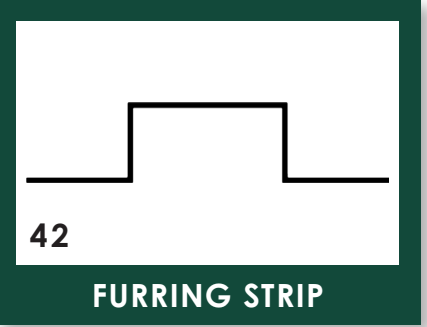
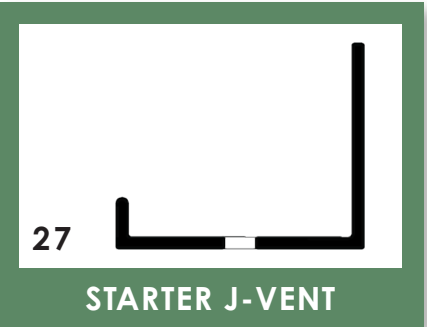
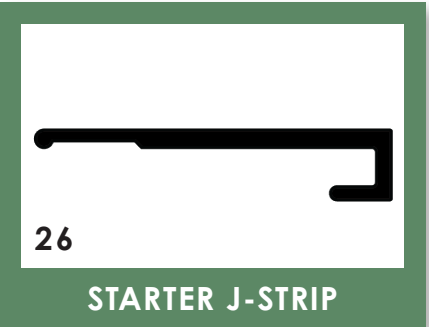
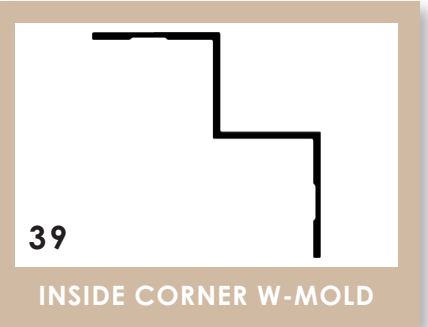
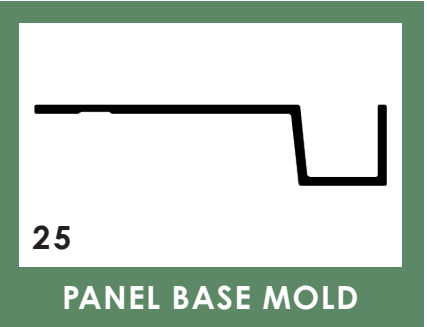
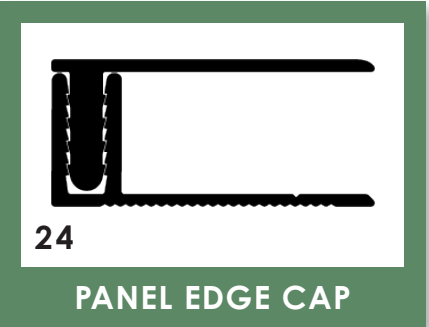
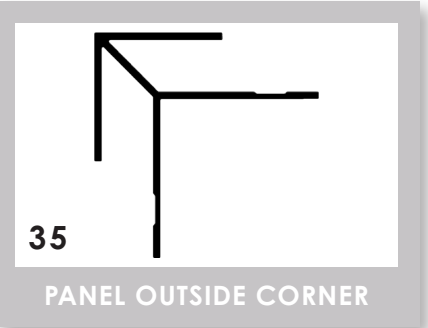
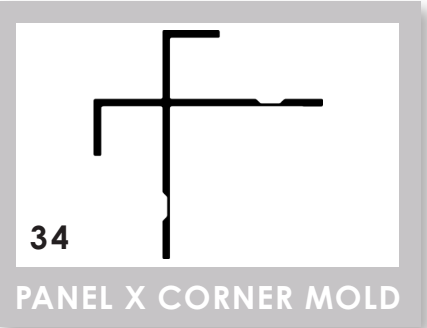
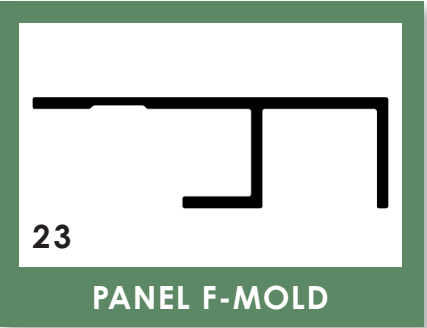
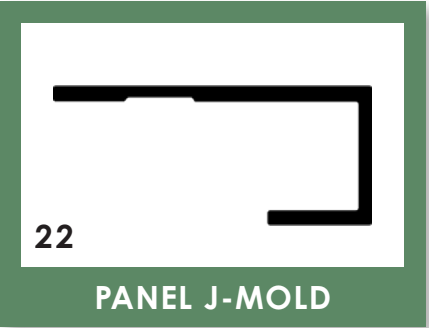
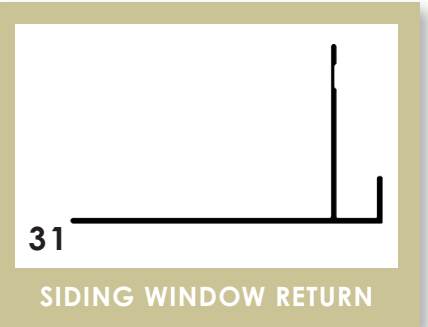
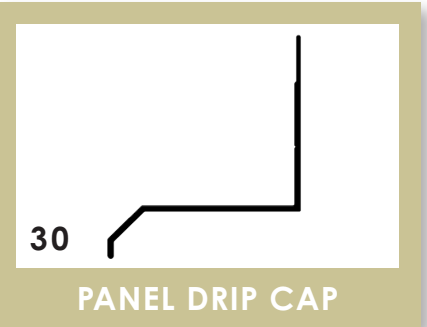
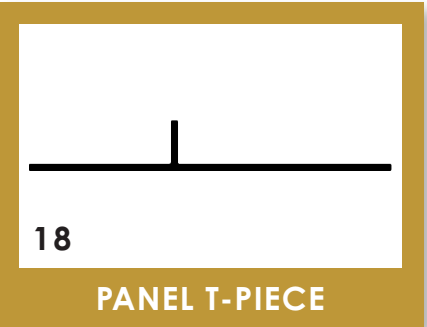
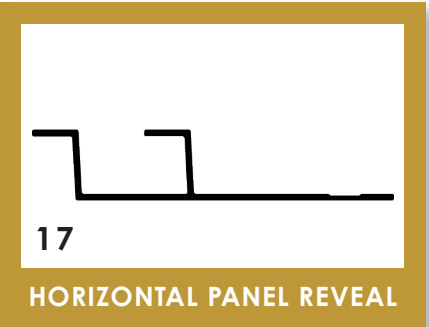
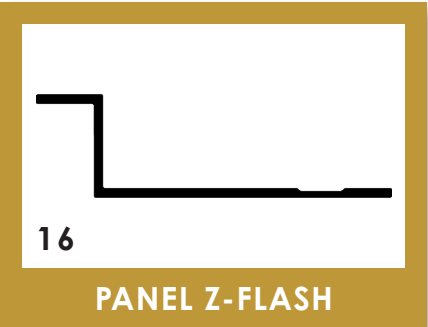
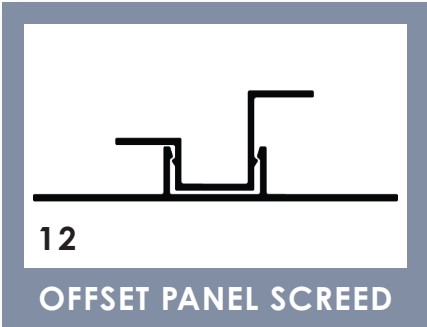
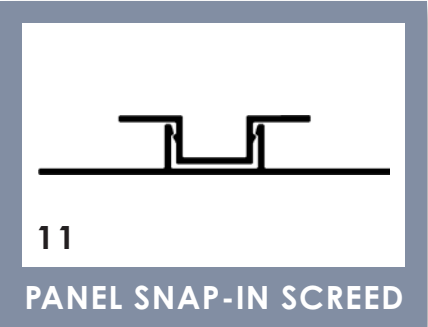
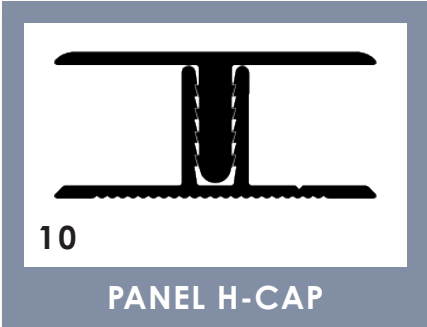
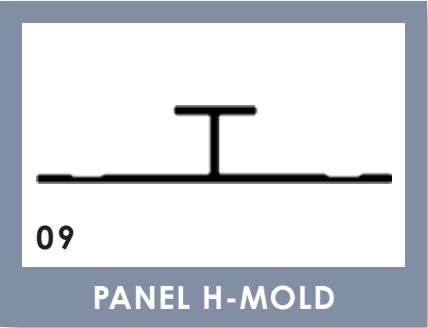
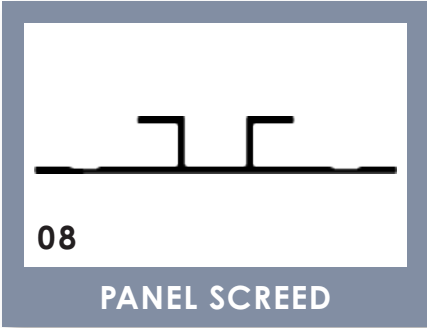

A photograph of a modern commercial building, 'The Container Store', featuring vertical reveal siding. The building has a mix of dark brown and light grey horizontal panels. Large blue letters spell out 'The Container Store' on the upper level, with a blue sign below it that says 'NOW OPEN!'. The ground floor has large glass windows and doors. A tall black light pole stands in front of the building. In the foreground, there are white storage containers and a grey SUV parked in a lot. The sky is blue with some clouds.

VERTICAL REVEALS

- PANEL SCREED
- PANEL H- MOLD
- PANEL H- CAP
- PANEL SNAP-IN SCREED
- OFFSET PANEL SCREED

PANEL SCREED

TRIM PURPOSE

Flannery's Panel Screeds create a vertical reveal between two panels. The Panel Screed is an attractive alternative to butting one panel to another.

SPECIFICATIONS

Flannery's Panel Trims are standard extruded aluminum alloy 6063 T5 and have a typical .050" nominal wall thickness. Panel Trims come in 10' lengths and shall have a standard Clear Anodized, Chem Film Finish, or Mill Finish (for field priming & painting). Other factory finishes and custom paint orders are available.

PRODUCT CHART

PART NO.	"A" DEPTH	"B" WIDTH	"C" WIDTH	PANEL THICKNESS
CPS 375-50	3/8"	1/2"	3/8"	3/8"
CPS 50-50	1/2"	1/2"	3/8"	1/2"
WPR 75-375-50	3/4"	1/2"	3/8"	3/4"

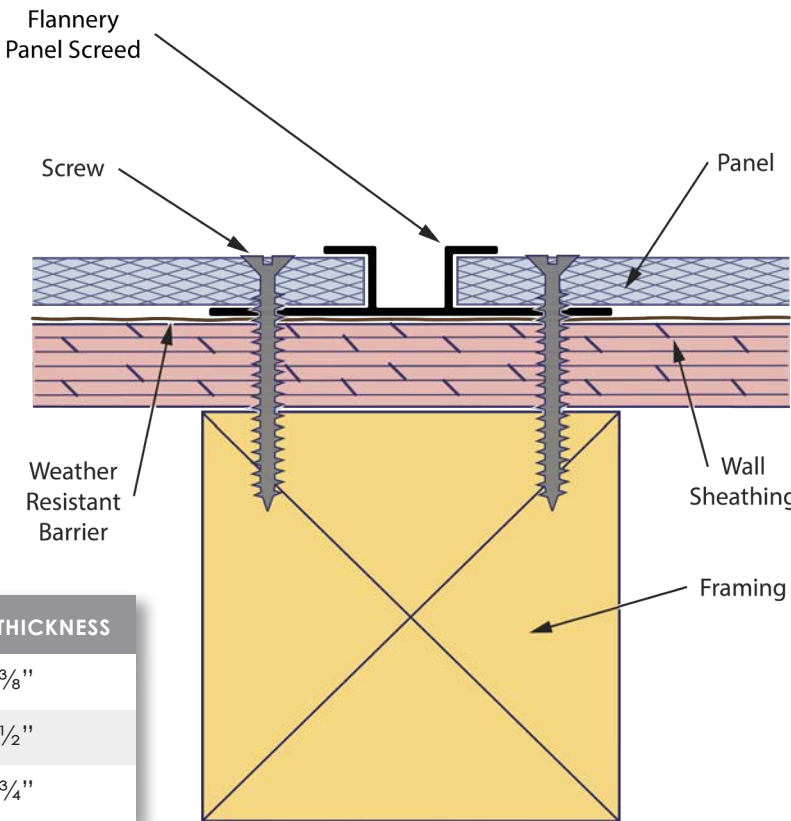
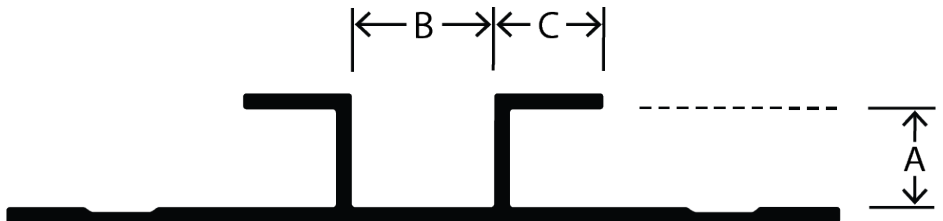

PANEL H-MOLD

TRIM PURPOSE

Flannery's Panel H-Mold creates a vertical "flat-face" reveal between two adjoining panels. The Panel H-Mold is an attractive alternative to butting one panel to another.

SPECIFICATIONS

Flannery's Panel Trims are standard extruded aluminum alloy 6063 T5 and have a .050" nominal wall thickness. Panel Trims come in 10' lengths and shall have a standard Clear Anodized or Chem-Film Finish (for field priming & painting). Other factory finishes and custom paint orders are available.

PRODUCT CHART

PART NO.	"A" DEPTH	"B" WIDTH	PANEL THICKNESS
CPH 375-50	3/8"	1/2"	3/8"
SHM 625-100	5/8"	1"	5/8"
WPH 75-375	3/4"	3/8"	3/4"
WPH 75-50	3/4"	1/2"	3/4"
SHM 875-100	7/8"	1"	7/8"
SHM 1125-1250	1 1/8"	1 1/4"	1 1/8"

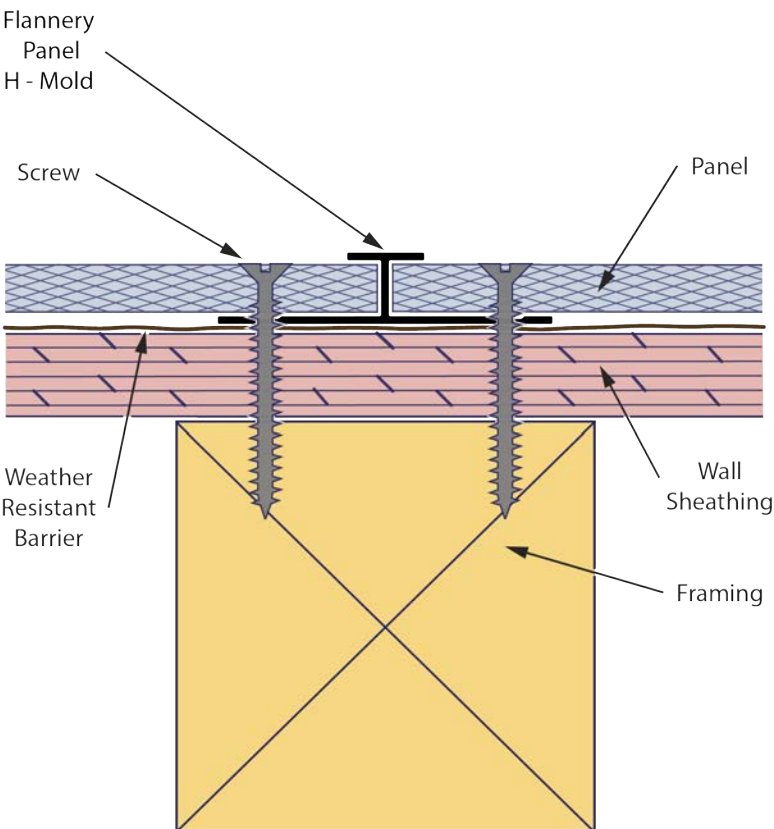
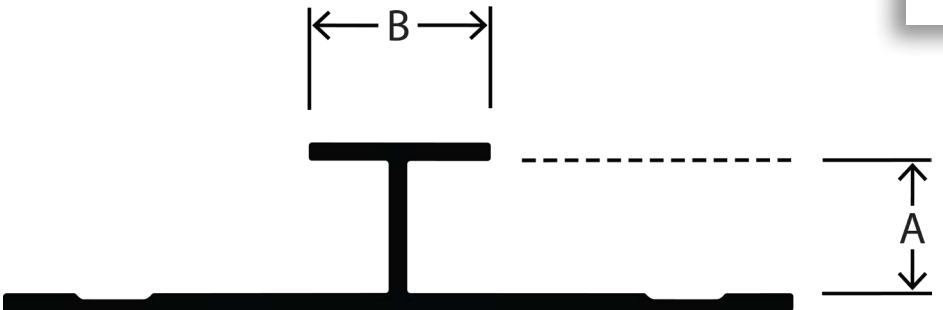

PANEL H-CAP

TRIM PURPOSE

Flannery's Panel H-Cap creates a vertical "flat-face" reveal between two panels. The Panel H-Cap is unique in that it allows for an easier installation of a vertical trim when used with paneling since the Base Mold of the H-Cap is installed prior to the paneling. Once the paneling is installed the H-Cap can be "snapped-in" to the Base Mold saving the installer the trouble of having to tuck the panels in behind the trim flanges.

SPECIFICATIONS

Flannery's Panel Trims are standard extruded aluminum alloy 6063 T5 and have a .050" nominal wall thickness. Cement Panel Trims come in 10' lengths and shall have a standard Clear Anodized or Chem-Film Finish (for field priming & painting). Other factory finishes and custom paint orders are available.

PRODUCT CHART

PART NO.	"A" DEPTH	"B" WIDTH	PANEL THICKNESS
SHC 460-1250	7/16"	1 1/4"	7/16"

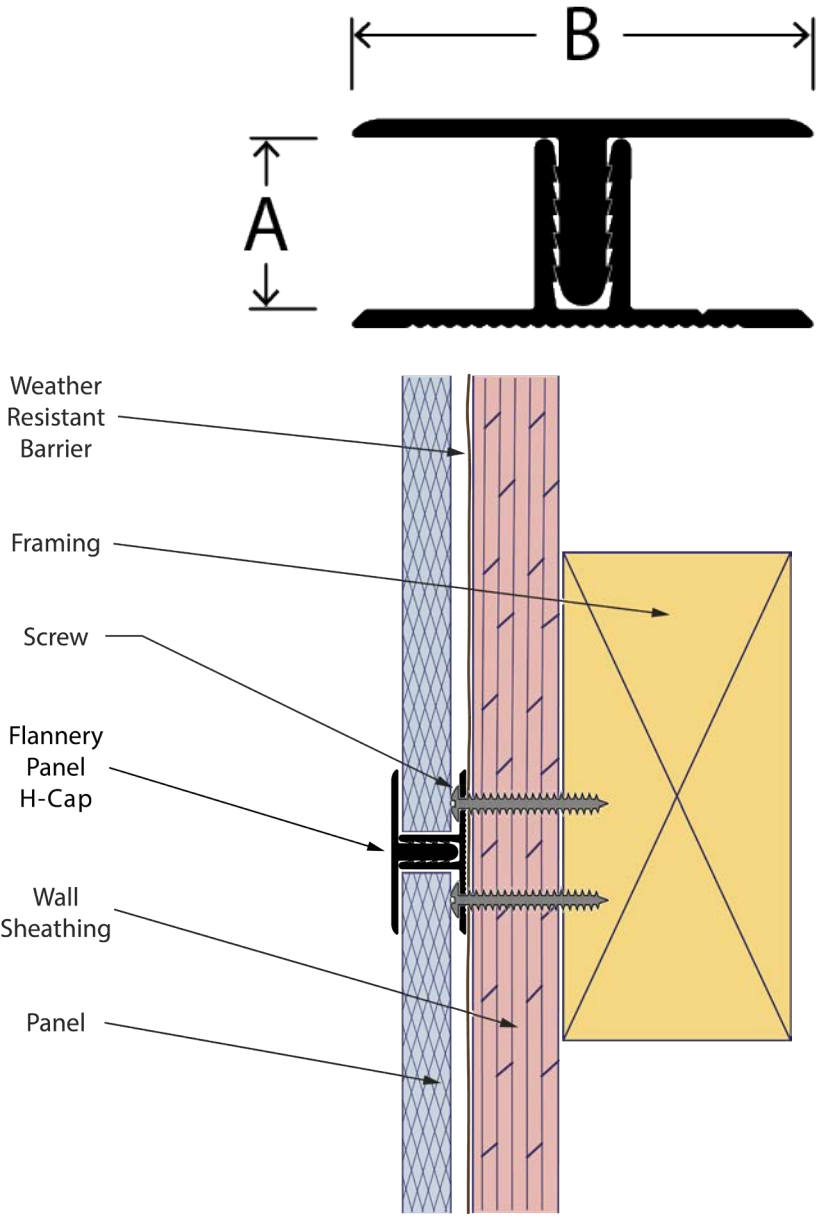

PANEL SNAP-IN SCREED

TRIM PURPOSE

Flannery's Snap-In Panel Screeds create a vertical reveal between two panels. The Snap-In Panel Screeds are unique in that they allow for an easier installation of a vertical reveal when used with paneling since the Base Mold of the Snap-In Panel Screed is installed prior to the paneling. Once the paneling is installed the Reveal Screed can be "snapped-in" to the Base Mold saving the installer the trouble of having to tuck the panels in between the screed flanges.

SPECIFICATIONS

Flannery's Panel Trims are standard extruded aluminum alloy 6063 T5 and have a .050" nominal wall thickness. Panel Trims come in 10' lengths and shall have a standard Clear Anodized or Chem-Film Finish (for field priming & painting). Other factory finishes and custom paint orders are available.

PRODUCT CHART

PART NO.	"A" DEPTH	"B" WIDTH	"C" WIDTH	PANEL THICKNESS
SCPS 375-50	3/8"	1/2"	3/8"	3/8"
SCPS 75-50	3/4"	1/2"	3/8"	3/4"

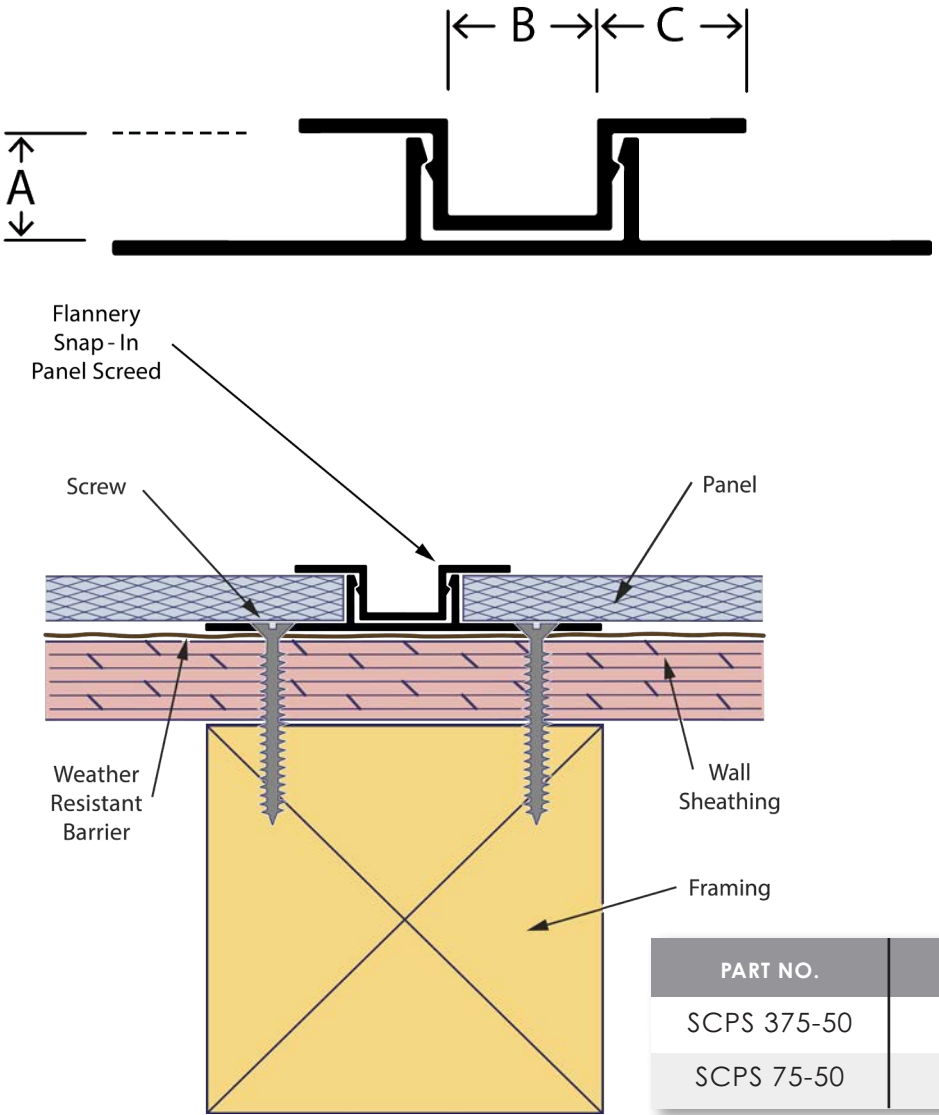

OFFSET PANEL SCREED

TRIM PURPOSE

Flannery's Snap-In Offset Panel Screed creates a vertical reveal between two different thicknesses of panels. The Snap-In Offset Panel Screed is unique in that it allows for an easier installation of a vertical reveal when used with two different thicknesses of paneling since the Base Mold of the Snap-In Offset Panel Screed is installed prior to the paneling. Once the paneling is installed the Reveal Screed can be "snapped-in" to the Base Mold saving the installer the trouble of having to tuck the panels in behind the reveal flanges.

SPECIFICATIONS

Flannery's Panel Trims are standard extruded aluminum alloy 6063 T5 and have a .050" nominal wall thickness. Cement Panel Trims come in 10' lengths and shall have a standard Clear Anodized or Chem-Film Finish (for field priming & painting). Other factory finishes and custom paint orders are available.

PRODUCT CHART

PART NO.	"A" DEPTH	"B" DEPTH	"C" WIDTH	"D" WIDTH	PANEL THICKNESS
SOPC 75-375-50	¾"	⅜"	½"	⅜"	¾" X ⅜"

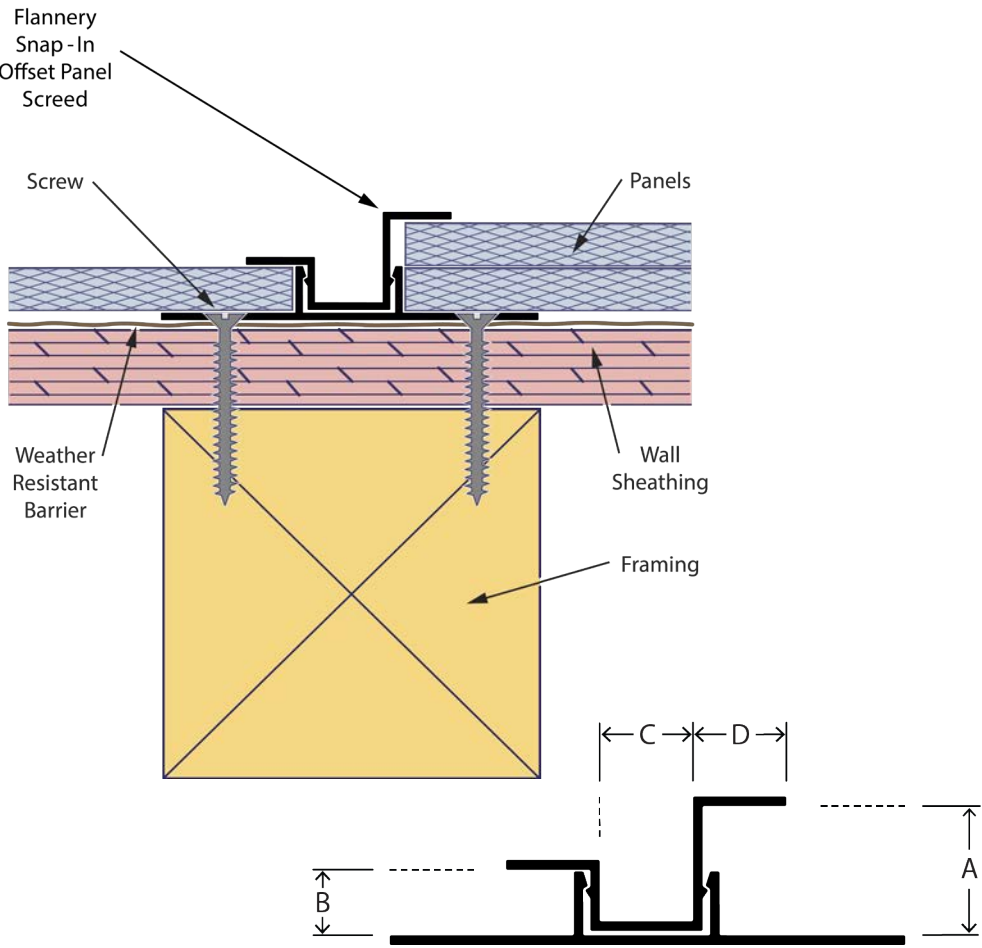



HORIZONTAL REVEALS

- PANEL Z-FLASH
- HORIZONTAL PANEL REVEAL
- PANEL T-PIECE

PANEL Z-FLASH

TRIM PURPOSE

Flannery's Panel Z-Flash creates a horizontal reveal between two panels. The Panel Z-Flash assists in moving moisture out from behind panels and away from the weather resistant barrier.

SPECIFICATIONS

Flannery's Panel Trims are standard extruded aluminum alloy 6063 T5 and have a typical .050" nominal wall thickness. Panel Trims come in 10' lengths and shall have a standard Clear Anodized, Chem Film Finish, or Mill Finish (for field priming & painting). Other factory finishes and custom paint orders are available.

PRODUCT CHART

PART NO.	"A" DEPTH	"B" WIDTH	PANEL THICKNESS
CPZ 50	1/2"	3/8"	1/2"
CPZ 625	5/8"	3/8"	5/8"

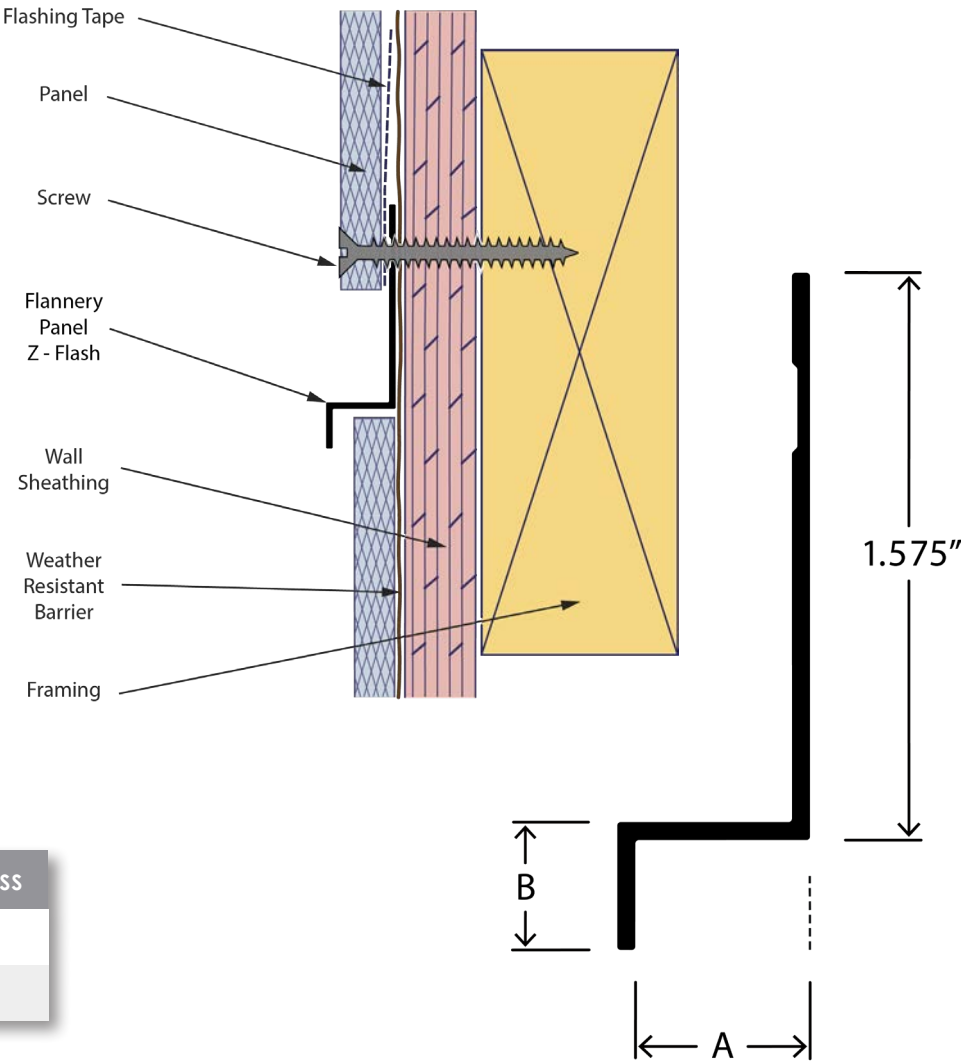

HORIZONTAL PANEL REVEAL

TRIM PURPOSE

Flannery's Horizontal Panel Reveal creates a horizontal reveal between two panels and mimics the Panel Screed when used together.

SPECIFICATIONS

Flannery's Panel Trims are standard extruded aluminum alloy 6063 T5 and have a .050" nominal wall thickness. Panel Trims come in 10' lengths and shall have a standard Clear Anodized or Chem-Film Finish (for field priming & painting). Other factory finishes and custom paint orders are available.

PRODUCT CHART

PART NO.	"A" DEPTH	"B" WIDTH	"C" WIDTH	PANEL THICKNESS
CPHR 375-50	1/2"	1/2"	3/8"	1/2"

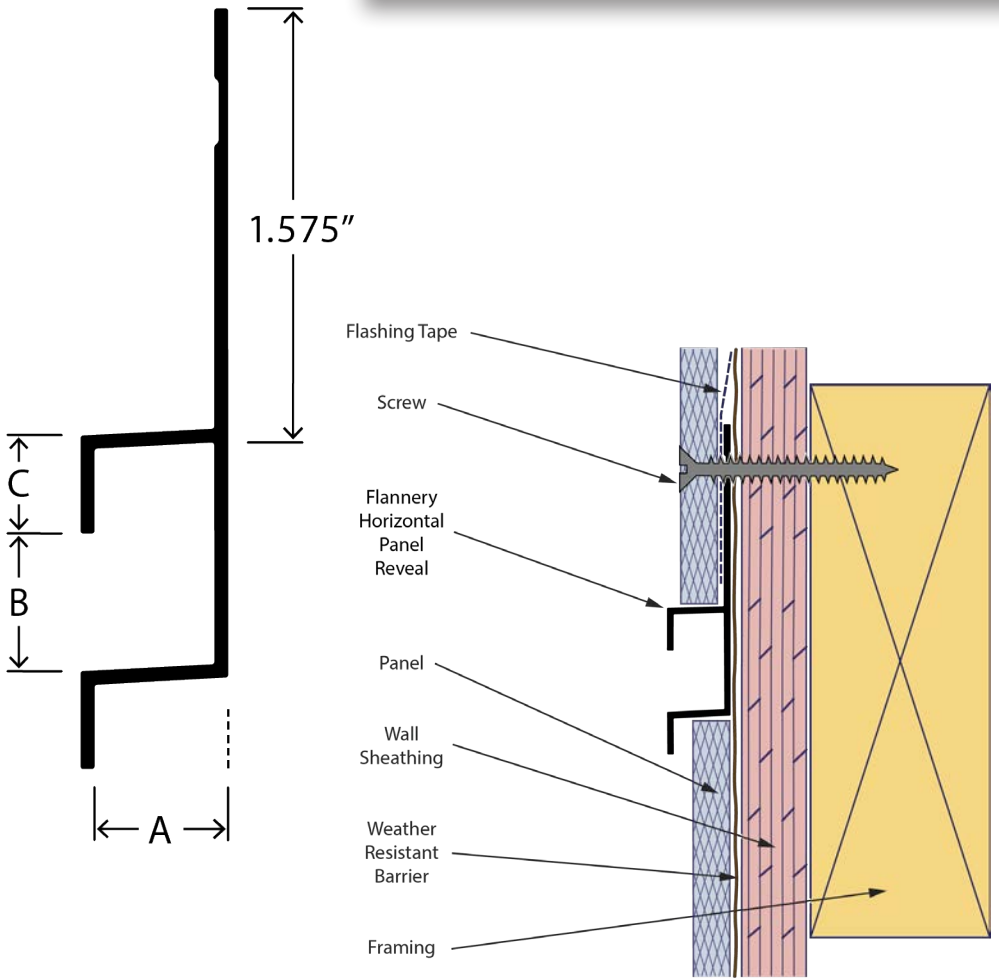

PANEL T-PIECE

TRIM PURPOSE

Flannery's Panel T-Piece is a trim that allows for a horizontal reveal between two panels.

SPECIFICATIONS

Flannery's Panel Trims are standard extruded aluminum alloy 6063 T5 and have a typical .050" nominal wall thickness. Panel Trims come in 10' lengths and shall have a standard Clear Anodized, Chem Film Finish, or Mill Finish (for field priming & painting). Other factory finishes and custom paint orders are available.

PRODUCT CHART

PART NO.	"A" DEPTH	"B" WIDTH	"C" WIDTH	PANEL THICKNESS
PTP 35-250	1 ¹¹ / ₃₂ "	1 1/2"	1"	3/8"

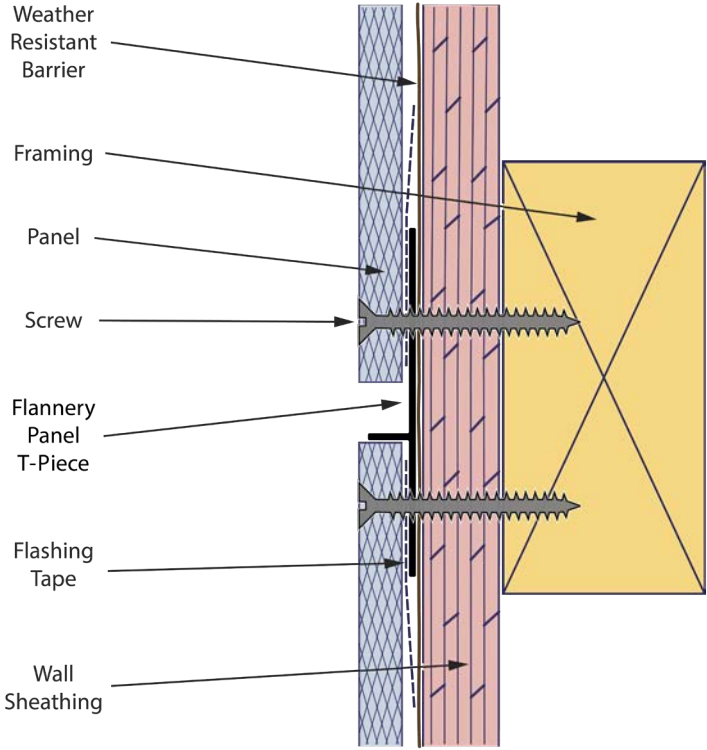
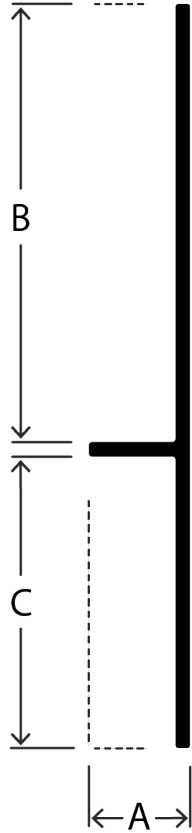



TERMINATION TRIMS

- PANEL J-MOLD
- PANEL F-MOLD
- PANEL EDGE CAP
- PANEL BASE MOLD
- STARTER J-STRIP
- STARTER J-VENT

PANEL J-MOLD

TRIM PURPOSE

Flannery's Panel J-Mold is an edge trim, which helps finish panels that terminate against dissimilar materials such as doors or windows.

SPECIFICATIONS

Flannery's Panel Trims are standard extruded aluminum alloy 6063 T5 and have a typical .050" nominal wall thickness.

PRODUCT CHART

PART NO.	"A" DEPTH	"B" WIDTH	PANEL THICKNESS
CPJ 375-375	3/8"	3/8"	3/8"
SJM 460-50	7/16"	1/2"	7/16"
CPJ 50-375	1/2"	3/8"	1/2"
SJM 625-100	5/8"	1"	5/8"
WPJ 75-375	3/4"	3/8"	3/4"
WPJ 75-50	3/4"	1/2"	3/4"
SJM 875-100	7/8"	1"	7/8"
SJM 1125-1250	1 1/8"	1 1/4"	1 1/8"
DEJ 1188-75	1 3/16"	3/4"	3/16"

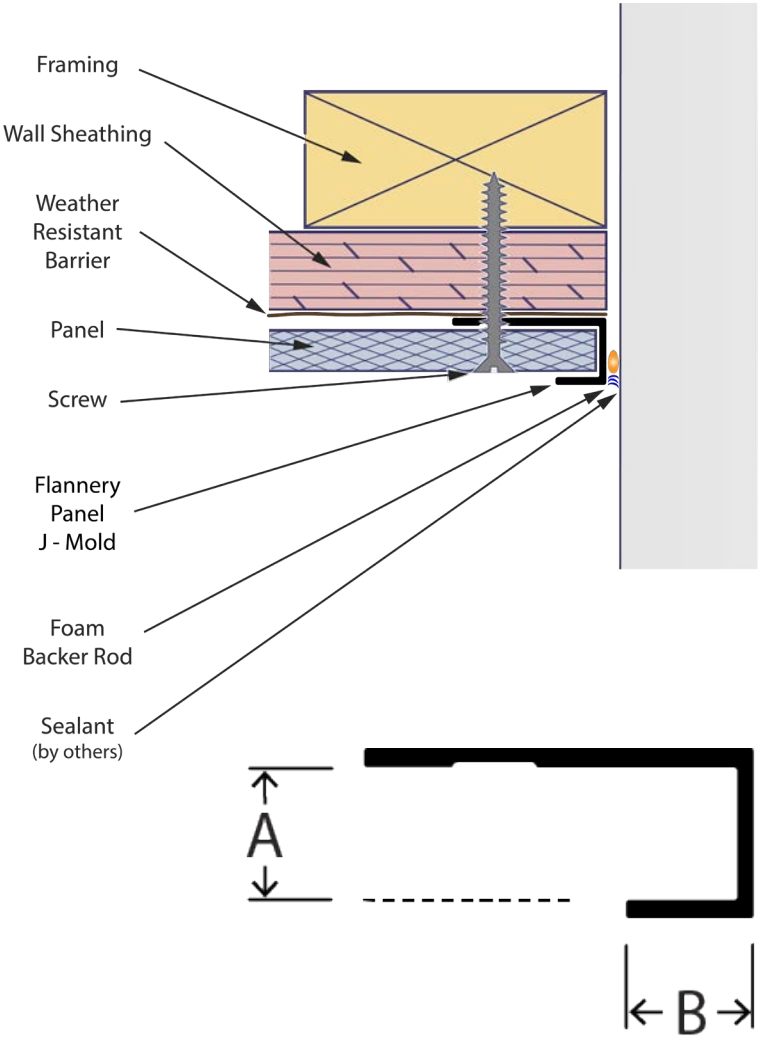

PANEL F-MOLD

TRIM PURPOSE

Flannery's Panel F-Mold creates an aesthetic termination reveal between a panel and a dissimilar material. The F-Mold is an attractive alternative to butting a panel directly against a dissimilar wall, door or window frame.

SPECIFICATIONS

Flannery's Panel Trims are standard extruded aluminum alloy 6063 T5 and have a .050" nominal wall thickness. Panel Trims come in 10' lengths and shall have a standard Clear Anodized or Chem-Film Finish (for field priming & painting). Other factory finishes and custom paint orders are available.

PRODUCT CHART

PART NO.	"A" DEPTH	"B" WIDTH	"C" WIDTH	PANEL THICKNESS
CPF 375-50	3/8"	1/2"	3/8"	3/8"
CPF 50-50	1/2"	1/2"	3/8"	1/2"
WPF 75-375-50	3/4"	1/2"	3/8"	3/4"

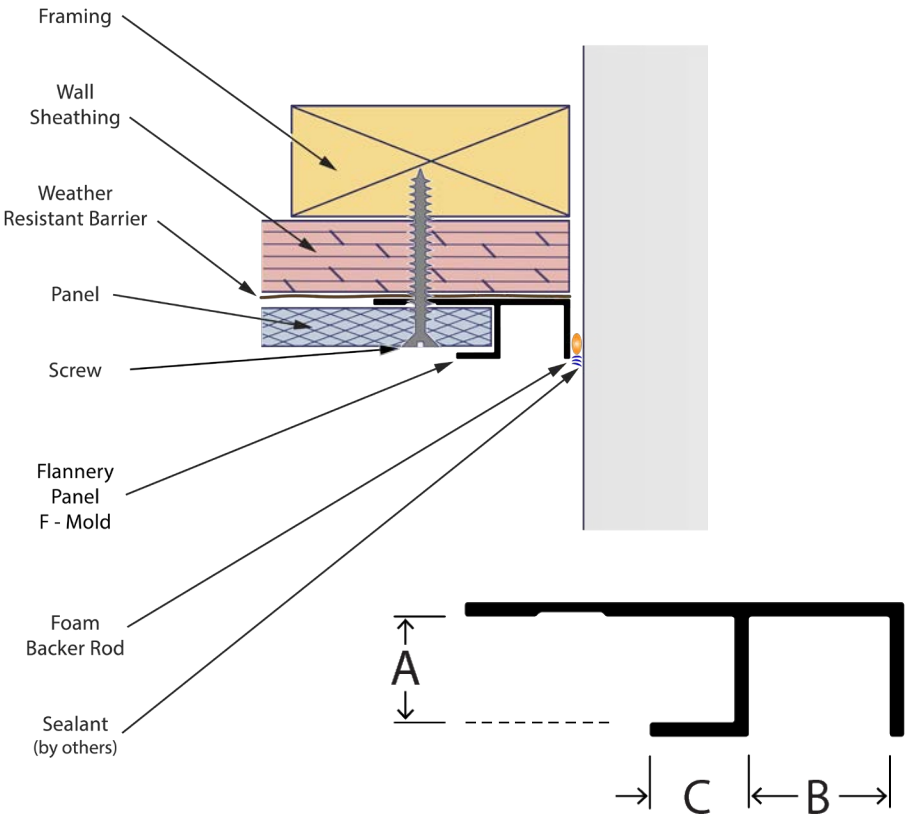

PANEL EDGE CAP

TRIM PURPOSE

Flannery's Panel Edge Cap is a termination trim for the edge of paneling that butt a dissimilar wall or material. The Panel Edge Cap is unique in that it allows for an easier installation of a trim when used with paneling since the Base Mold of the Edge Cap is installed prior to the paneling. Once the paneling is installed the Edge Cap can be "snapped-in" to the Base Mold saving the installer the trouble of having to tuck the panels in behind the trim's reveal flange.

SPECIFICATIONS

Flannery's Panel Trims are standard extruded aluminum alloy 6063 T5 and have a .050" nominal wall thickness. Cement Panel Trims come in 10' lengths and shall have a standard Clear Anodized or Chem-Film Finish (for field priming & painting). Other factory finishes and custom paint orders are available.

PRODUCT CHART

PART NO.	"A" DEPTH	"B" WIDTH	PANEL THICKNESS
SEC 460-1250	7/16"	1 1/4"	7/16"

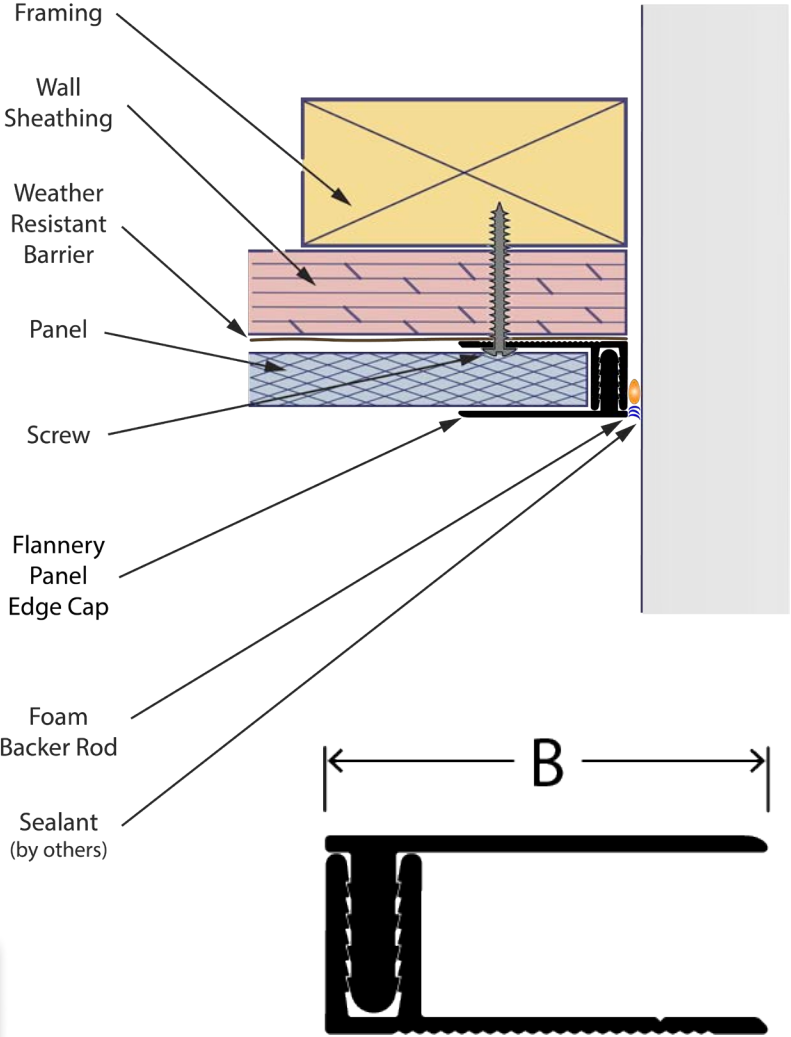

PANEL BASE MOLD

TRIM PURPOSE

Flannery's Panel Base Mold creates an aesthetic horizontal line at the bottom of a panel wall system. The top of the Panel Base Mold is sloped to allow moisture to run off of the top of the trim.

SPECIFICATIONS

Flannery's Panel Trims are standard extruded aluminum alloy 6063 T5 and have a .050" nominal wall thickness. Panel Trims come in 10' lengths and shall have a standard Clear Anodized or Chem-Film Finish (for field priming & painting). Other factory finishes and custom paint orders are available.

PRODUCT CHART

PART NO.	"A" DEPTH	"B" WIDTH	PANEL THICKNESS
CPB 375-50	3/8"	1/2"	3/8"

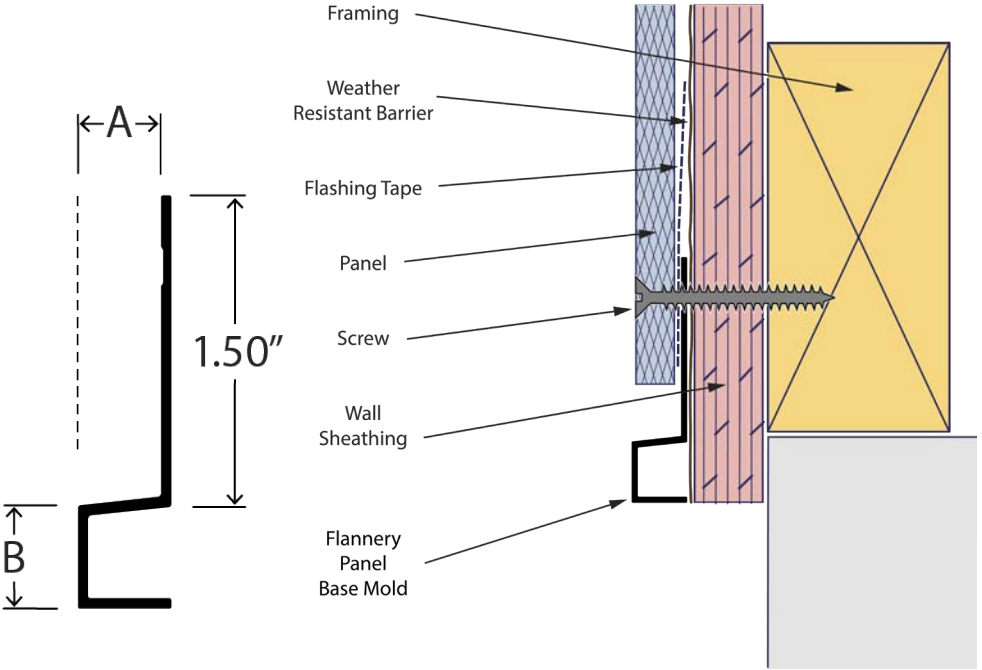

STARTER J-STRIP

TRIM PURPOSE

Flannery's Starter J-Strip is a siding trim which is designed to enable a panel installer to hang the first level of a siding or panel to a vertical wall. The Starter J-Strip is installed at the base of the wall where the first piece of siding will go on. The following layers of siding or panels then hook to each other in a typical tongue and groove process.

SPECIFICATIONS

Flannery's Panel Trims are standard extruded aluminum alloy 6063 T5 and have a typical .050" nominal wall thickness. Panel Trims come in 10' lengths and shall have a standard Clear Anodized, Chem Film Finish, or Mill Finish (for field priming & painting). Other factory finishes and custom paint orders are available.

PRODUCT CHART

PART NO.	"A" DEPTH	"B" DEPTH	"C" WIDTH
SJS 25-187	¼"	3/16"	1"
SJS 22-125	¼"	1/8"	1¼"

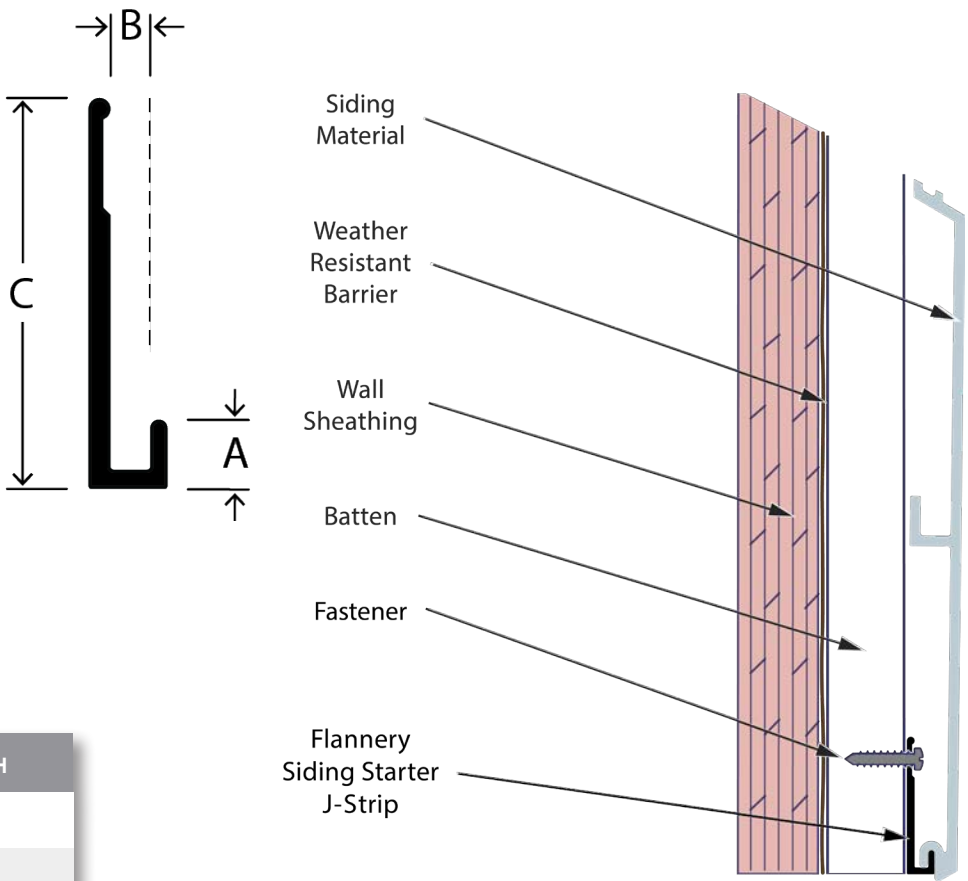

STARTER J-VENT

TRIM PURPOSE

Flannery's Starter J-Vent is a siding trim which is designed to enable a panel installer to hang the first level of a siding or panel to a vertical wall while also allowing for air flow behind the panels. That air flow in a typical rain screen effect will assist in drying the cavity behind the siding or panel material.

SPECIFICATIONS

Flannery's Panel Trims are standard extruded aluminum alloy 6063 T5 and have a .050" nominal wall thickness. Panel Trims come in 10' lengths and shall have a standard Clear Anodized or Chem-Film Finish (for field priming & painting). Other factory finishes and custom paint orders are available.

PRODUCT CHART

PART NO.	"A" DEPTH	"B" DEPTH	"C" WIDTH
SJV 100-V-875	1"	7/8"	¼"

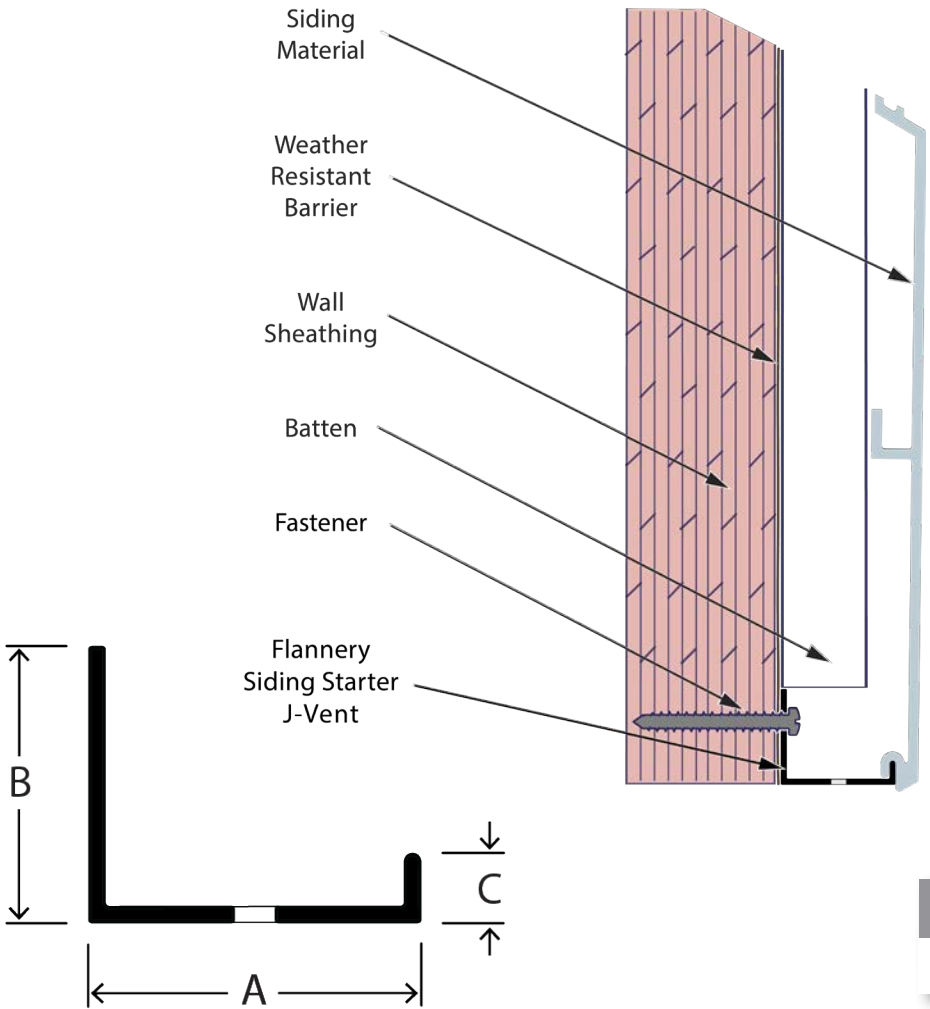

A photograph of a modern, multi-story building with a mix of light gray and dark gray panels. Several tall palm trees are in the foreground. The sky is clear blue. A white banner with the text 'DOOR & WINDOW TRIMS' is overlaid on the right side of the image.

DOOR & WINDOW TRIMS

- PANEL DRIP CAP
- SIDING WINDOW RETURN

PANEL DRIP CAP

TRIM PURPOSE

Flannery's Panel Drip Cap is a horizontal edge trim that creates an aesthetic reveal between two panels or where a panel is installed over a door or window. The Panel Drip Cap assists in moving moisture out from behind panels and away from the weather-resistant barrier.

SPECIFICATIONS

Flannery's Panel Trims are standard extruded aluminum alloy 6063 T5 and have a typical .050" nominal wall thickness. Panel Trims come in 10' lengths and shall have a standard Clear Anodized, Chem Film Finish, or Mill Finish (for field priming & painting). Other factory finishes and custom paint orders are available.

PRODUCT CHART

PART NO.	"A" DEPTH	"B" DEPTH	"C" WIDTH	PANEL THICKNESS
CPD 625	5/8"	1/4"	1 3/4"	5/8"
CPD 1250	1 1/4"	1/4"	1 3/4"	1 1/4"

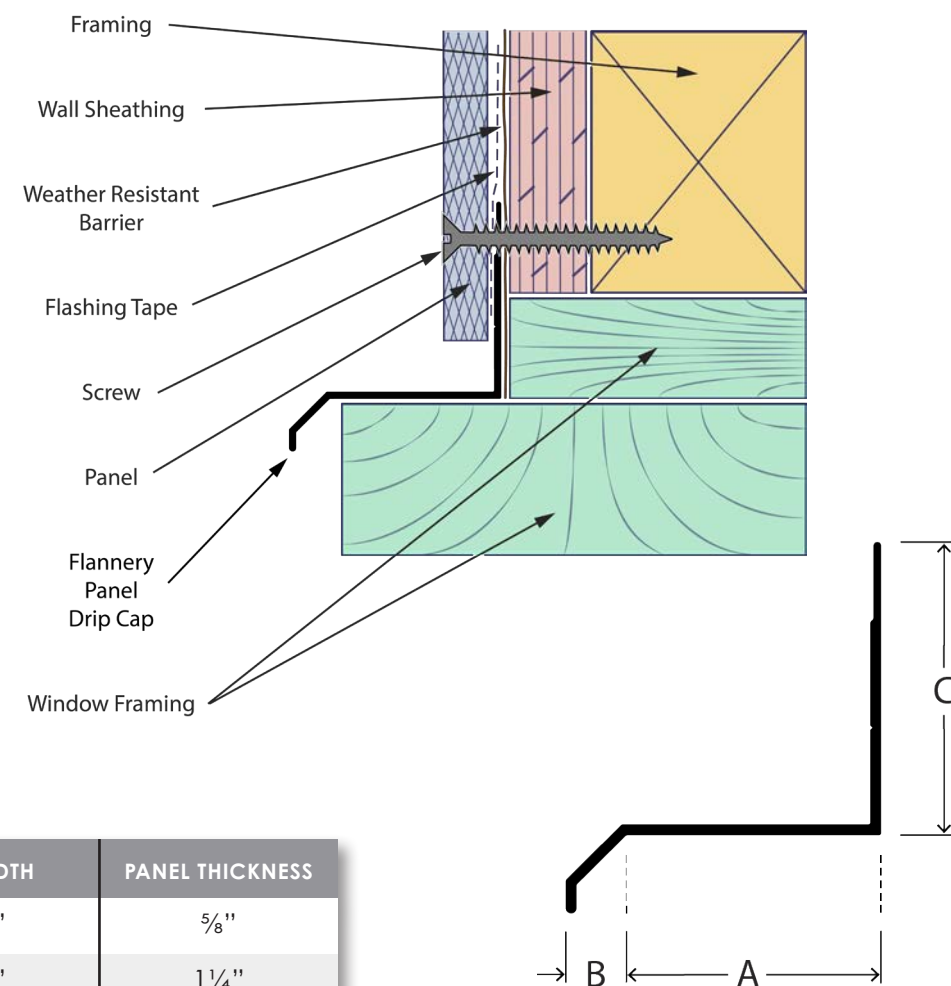

SIDING WINDOW RETURN

TRIM PURPOSE

Flannery's Siding Window Return creates an aesthetic termination point where a panel wall terminates at a recessed frame. The Siding Window Return eliminates the need for a small panel return where a wall terminates at the recess of a window opening.

SPECIFICATIONS

Flannery's Panel Trims are standard extruded aluminum alloy 6063 T5 and have a .050" nominal wall thickness. Panel Trims come in 10' lengths and shall have a standard Clear Anodized or Chem-Film Finish (for field priming & painting). Other factory finishes and custom paint orders are available.

PRODUCT CHART

PART NO.	"A" DEPTH	"B" WIDTH	"C" WIDTH	"D" WIDTH	PANEL THICKNESS
SWR 460-300	7/16"	3"	1/2"	2"	7/16"

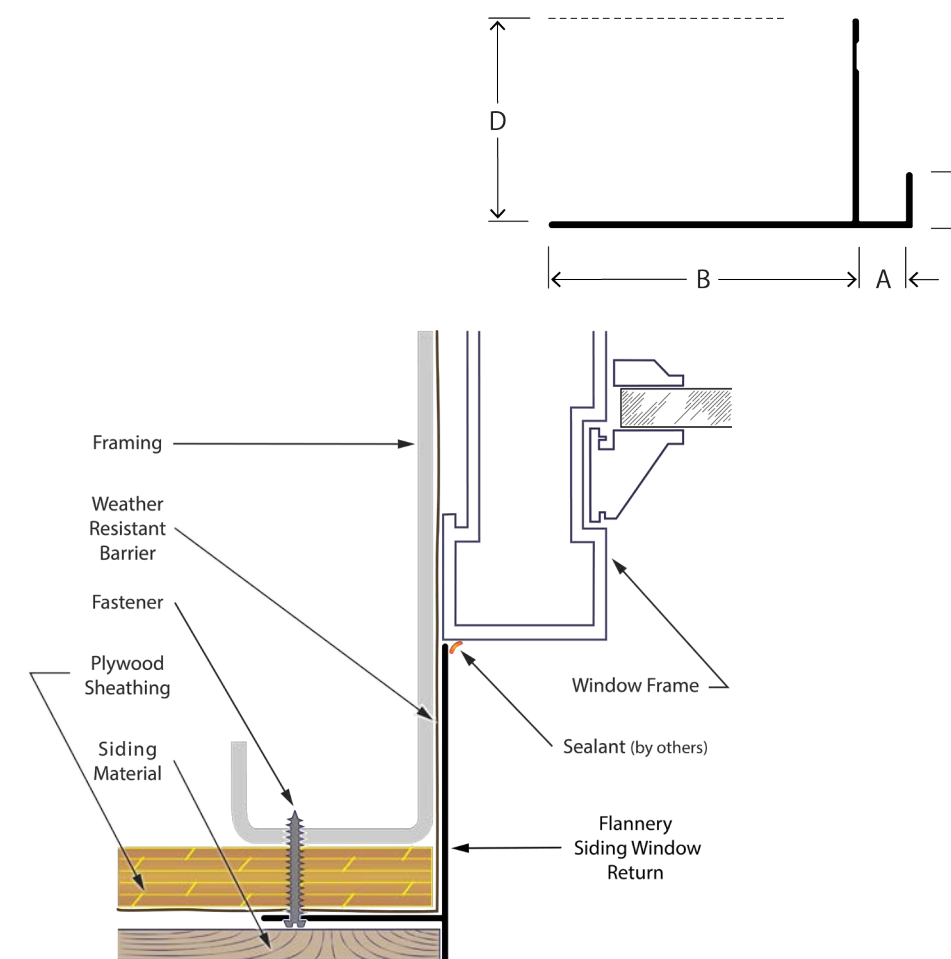



OUTSIDE CORNERS

- PANEL X-CORNER MOLD
- PANEL OUTSIDE CORNER

PANEL X-CORNER MOLD

TRIM PURPOSE

Flannery's Panel X-Mold is an outside corner trim that creates an aesthetic reveal where two panels come together at an outside 90° corner. The face flange on each side covers the edge of the panels without requiring them to be mitered at the edge.

SPECIFICATIONS

Flannery's Panel Trims are standard extruded aluminum alloy 6063 T5 and have a .050" nominal wall thickness. Panel Trims come in 10' lengths and shall have a standard Clear Anodized or Chem-Film Finish (for field priming & painting). Other factory finishes and custom paint orders are available.

PRODUCT CHART

PART NO.	"A" DEPTH	"B" WIDTH	PANEL THICKNESS
CPX 375-375	3⁄8"	3⁄8"	3⁄8"
CPX 50-375	1⁄2"	3⁄8"	1⁄2"
SXM 625-100	5⁄8"	1"	5⁄8"
WPX 75-375	3⁄4"	3⁄8"	3⁄4"
SXM 875-100	7⁄8"	1"	7⁄8"
SXM 1125-1250	1 1⁄8"	1 1⁄4"	1 1⁄8"

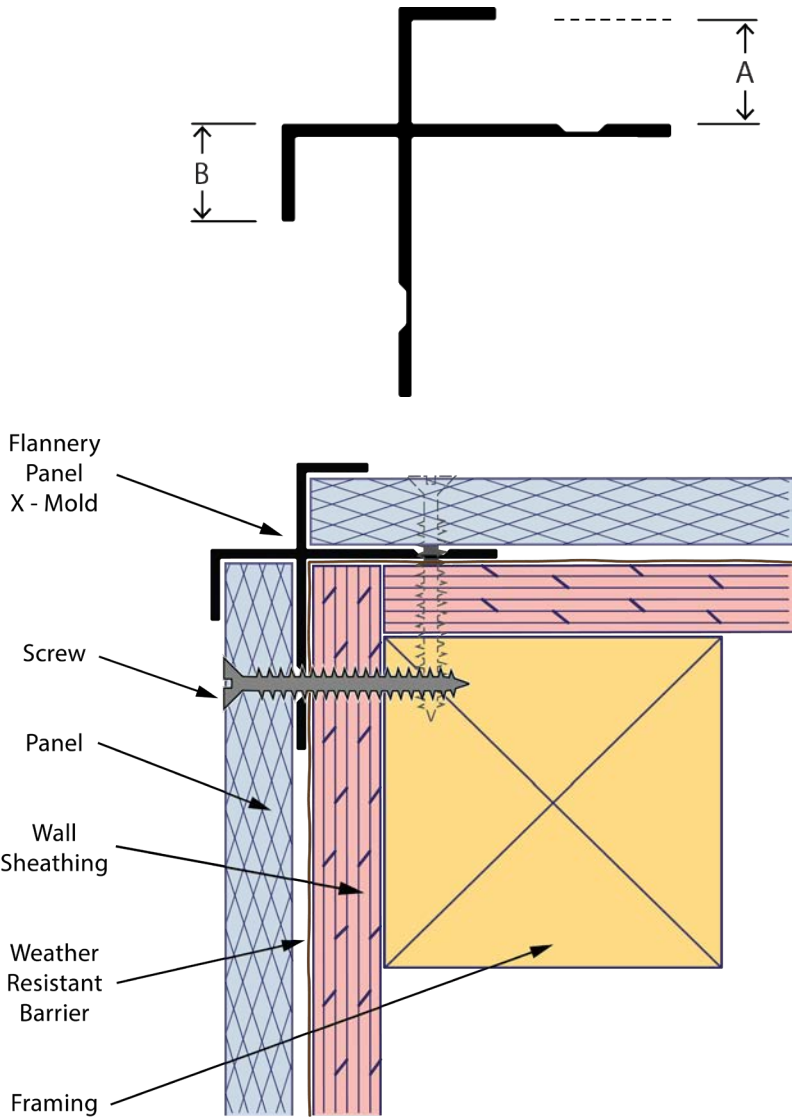

PANEL OUTSIDE CORNER

TRIM PURPOSE

Flannery's Panel Outside Corner is an outside corner trim that creates a sharp aesthetic corner where two panels come together at an outside 90° corner.

SPECIFICATIONS

Flannery's Panel Trims are standard extruded aluminum alloy 6063 T5 and have a .050" nominal wall thickness. Panel Trims come in 10' lengths and shall have a standard Clear Anodized or Chem-Film Finish (for field priming & painting). Other factory finishes and custom paint orders are available. For detailed installation instructions, please see back of brochure.

PRODUCT CHART

PART NO.	"A" DEPTH	"B" WIDTH	PANEL THICKNESS
CPOC 375-100	3⁄8"	1"	3⁄8"
SOC 460-100	7⁄16"	1"	7⁄16"
SOC 625-100	5⁄8"	1"	5⁄8"
WPOC 75-375	3⁄4"	3⁄8"	3⁄4"
WPOC 75-150	3⁄4"	1 1⁄2"	3⁄4"
SOC 875-100	7⁄8"	1"	7⁄8"

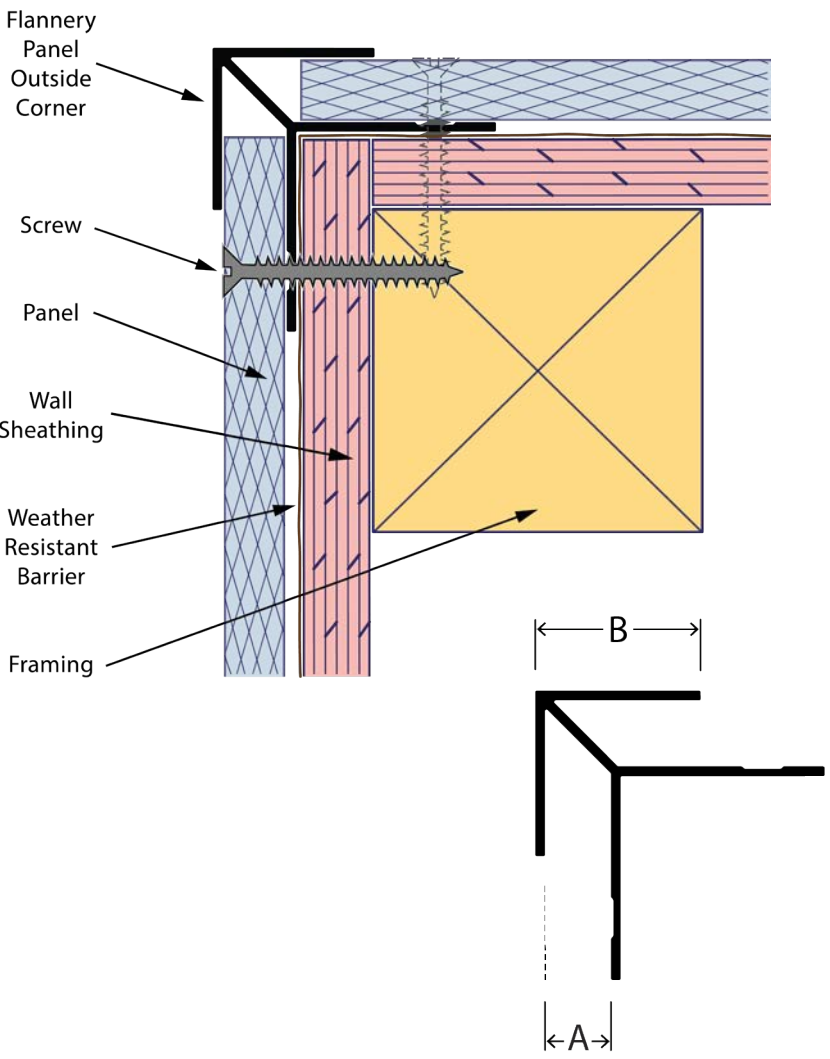



INSIDE CORNERS

- PANEL INSIDE CORNER REVEAL
- PANEL INSIDE CORNER W-MOLD

PANEL INSIDE CORNER REVEAL

TRIM PURPOSE

Flannery's Panel Inside Corner Reveal creates an aesthetic termination reveal between two panels that meet at an inside 90° corner. The Panel Inside Corner Reveal is an attractive alternative to simply butting two panels against one another at an inside corner.

SPECIFICATIONS

Flannery's Panel Trims are standard extruded aluminum alloy 6063 T5 and have a .050" nominal wall thickness. Panel Trims come in 10' lengths and shall have a standard Clear Anodized or Chem-Film Finish (for field priming & painting). Other factory finishes and custom paint orders are available.

PRODUCT CHART

PART NO.	"A" DEPTH	"B" WIDTH	PANEL THICKNESS
CPIC 375-50	3/8"	1/2"	3/8"
SIC 460-50	7/16"	1/2"	7/16"
SIC 625-100	5/8"	1"	5/8"
WPIC 75-375	3/4"	3/8"	3/4"
SIC 875-100	7/8"	1"	7/8"

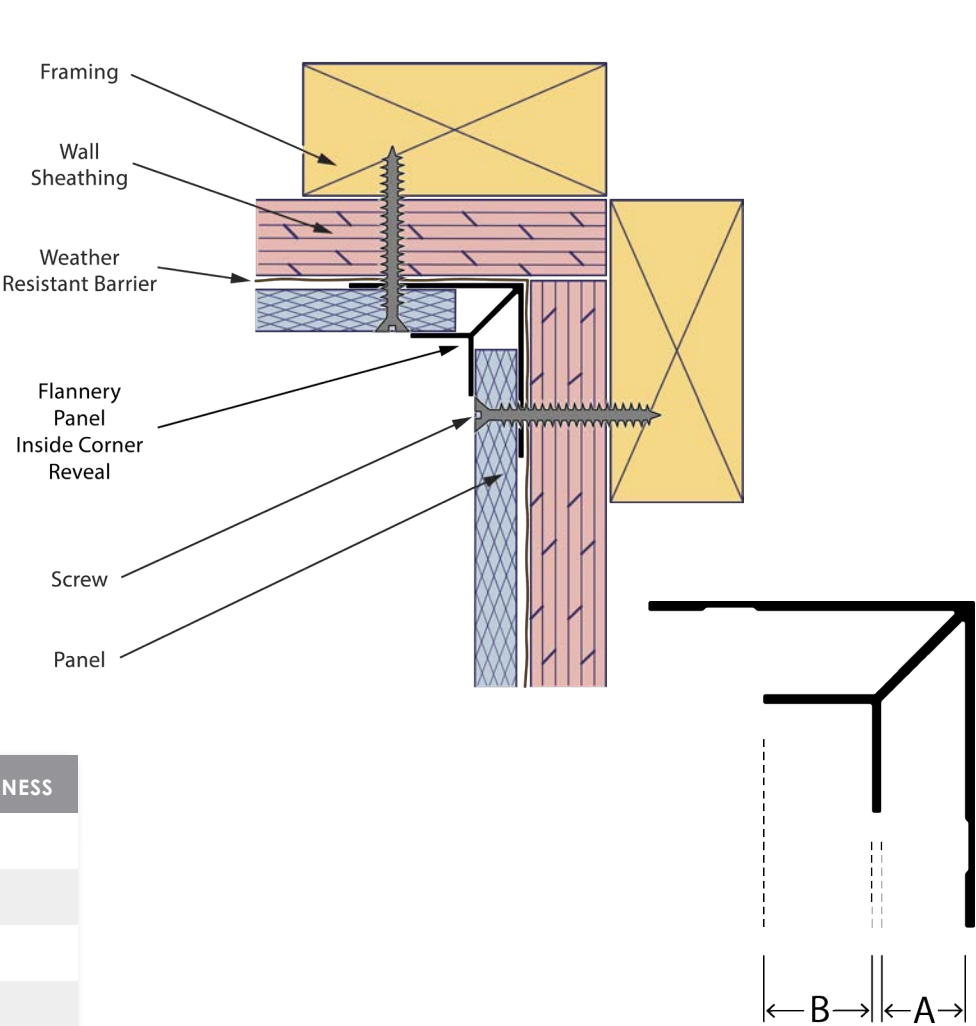

PANEL INSIDE CORNER W-MOLD

TRIM PURPOSE

Flannery's Panel W-Mold is an inside corner trim that creates a termination point between two panels that meet at an inside 90° corner.

SPECIFICATIONS

Flannery's Panel Trims are standard extruded aluminum alloy 6063 T5 and have a .050" nominal wall thickness. Panel Trims come in 10' lengths and shall have a standard Clear Anodized or Chem-Film Finish (for field priming & painting). Other factory finishes and custom paint orders are available.

PRODUCT CHART

PART NO.	"A" DEPTH	"B" WIDTH	PANEL THICKNESS
CPW 50-50	1/2"	1/2"	1/2"
CPW 625-625	5/8"	5/8"	5/8"
WTM 75-75	3/4"	3/4"	3/4"

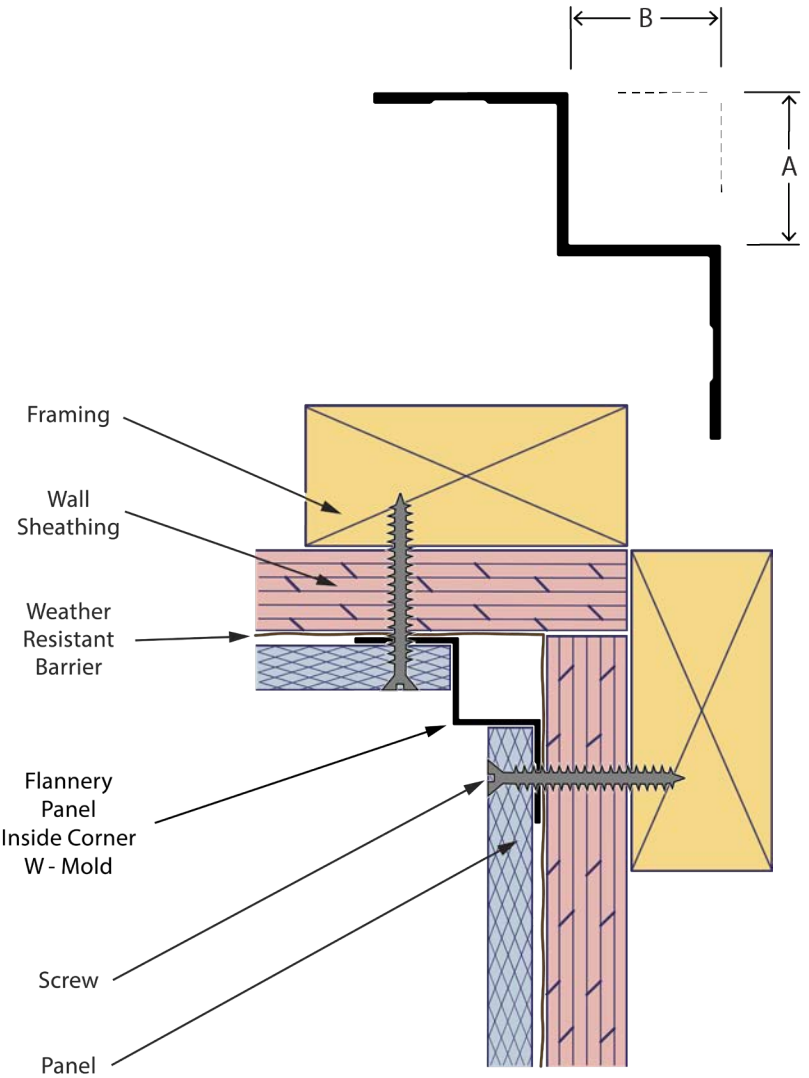



FURRING STRIPS

- FURRING STRIP
- Z-FUR STRIP

FURRING STRIP

TRIM PURPOSE

Flannery's Aluminum Furring Strip is designed to hold panels or composite siding away from the substrate in order to allow for the movement of air behind the panels. Since our furring strips are manufactured with aluminum, they will never rot or rust out from behind the wall system.

SPECIFICATIONS

Flannery's Panel Trims are standard extruded aluminum alloy 6063 T5 and have a typical .050" nominal wall thickness. Panel Trims come in 10' lengths and shall have a standard Clear Anodized, Chem Film Finish, or Mill Finish (for field priming & painting). Other factory finishes and custom paint orders are available.

PRODUCT CHART

PART NO.	"A" DEPTH	"B" WIDTH	"C" WIDTH
FUR 375-100	3/8"	1"	1"
FUR 75-150	3/4"	1 1/2"	1"

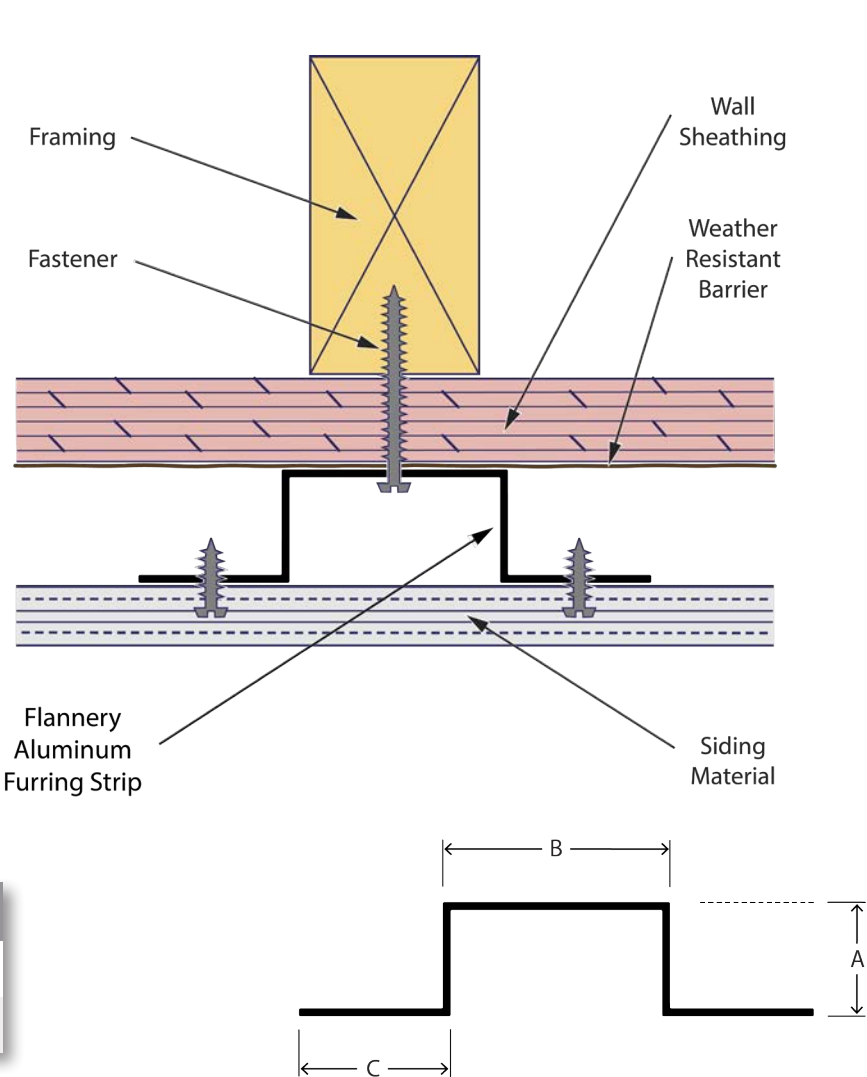

Z-FUR STRIP

TRIM PURPOSE

Flannery's Z-Furring Strips were designed to hold panels or composite siding away from the substrate in order to allow for the movement of air behind the panels. The Z-Fur strips are an extruded aluminum product, which means they will never rot or rust out from behind the wall system.

SPECIFICATIONS

Flannery's Panel Trims are standard extruded aluminum alloy 6063 T5 and have a .050" nominal wall thickness. Panel Trims come in 10' lengths and shall have a standard Clear Anodized or Chem-Film Finish (for field priming & painting). Other factory finishes and custom paint orders are available.

PRODUCT CHART

PART NO.	"A" DEPTH	"B" WIDTH	"C" WIDTH
ZFS 75-75	3/4"	3/4"	3/4"

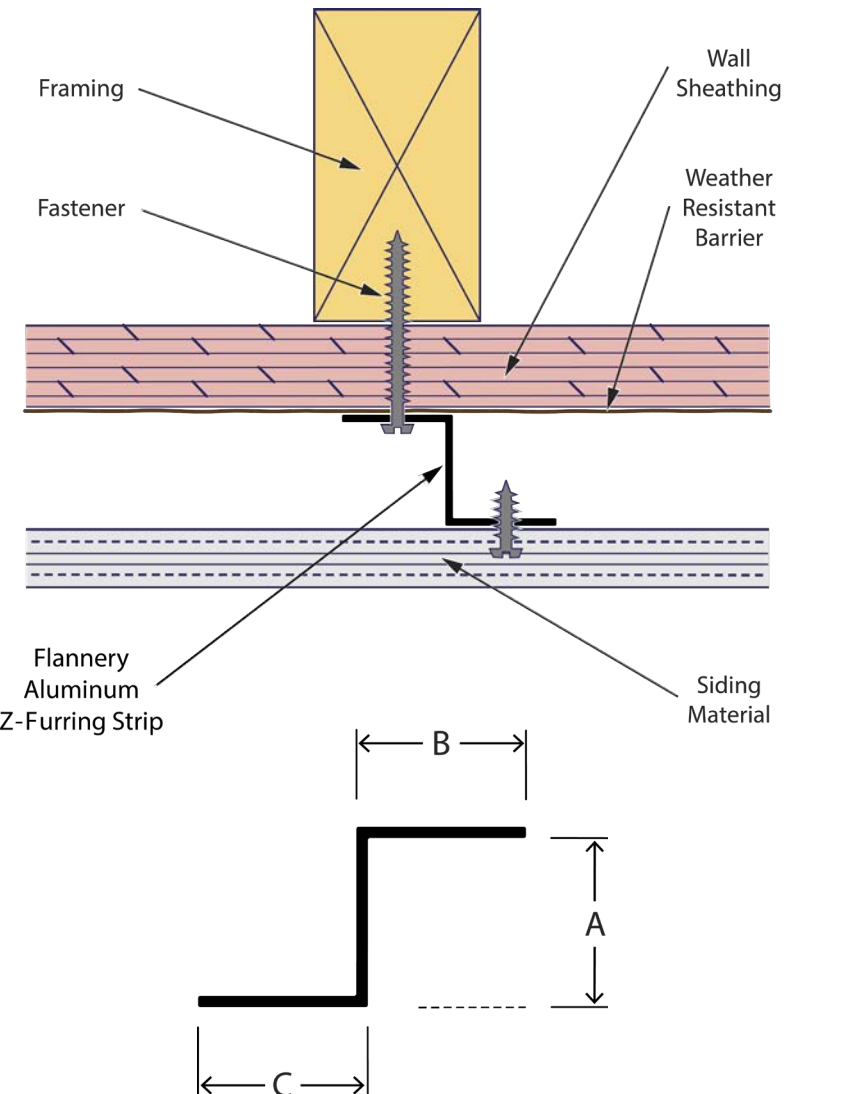



INSTALLATION DETAILS



ALUMINUM PANEL TRIM BEST PRACTICES

HANDLING ALUMINUM TRIMS

Personal protection equipment should be utilized when handling and installing aluminum trims. Gloves and eye protection must be worn when handling aluminum trims as well as ear protection when cutting them.

CUTTING ALUMINUM MOLDINGS

Flannery recommends that full ten-foot lengths be used wherever possible. Aluminum Moldings can be cut with a chop saw, using a 125-150-tooth carbide-tip blade for non-ferrous metal. An abrasive cut-off wheel should not be used to cut aluminum trims. Blade lubricant (WD-40 or grease stick) must be applied to the blade before each cut. Lubricant should be cleaned off of trim prior to installation.

STEPS FOR FIELD PAINTING

Mill Finish (raw) or Chem-Film Treated Aluminum Moldings

1. Clean and treat moldings in accordance with the paint manufacturer's specifications.
2. Use a primer recommended by the paint manufacturer.
3. Apply the paint coat according to the paint manufacturer's specifications.

Clear Anodized Aluminum Moldings

If field painting of clear anodized moldings is necessary, the following steps must be taken to improve the bond between the paint and the aluminum surface:

1. Clean and treat moldings with an acid etch solution (i.e. mild concentration of muriatic acid), then rinse thoroughly and allow to dry. An "acid-etched" primer is also available depending on the paint manufacturer's recommendations.
2. Use a primer recommended by the paint manufacturer.
3. Apply the paint coat according to the paint manufacturer's specifications.
4. Flannery makes no guarantees, nor accepts any responsibility, for the performance of field-applied coatings over anodized finishes.

SPECIFICATIONS FOR INTERIOR USE OF PANEL TRIMS

Flannery recommends that any installer of Aluminum Panel Trims properly layout and coordinate the install of trims along with the particular paneling that will be utilized in a given installation. Proper planning will reduce installation time and produce the desired design aesthetic.

SPECIFICATIONS FOR EXTERIOR USE OF PANEL TRIMS

It is important for the installer to be aware of certain restrictions when installing Aluminum Panel Trims on an exterior wall. Certain trims are designed specifically for vertical or horizontal installation to allow for the proper movement of moisture around the paneling. Trim installed improperly could lead to moisture intrusion or a poor wall design. Please refer to www.flannerytrim.com for a more comprehensive installation guide of exterior panel trims.

INSTALLING PANEL TRIMS

When Installing Vertically

A weather resistant barrier must be placed behind all moldings and have a shiplap of 6". Attach moldings 16" on center to framing using approved fastening methods. Butt joints must be cut accurately and sealed.

When Installing Horizontally

A weather resistant barrier must be placed behind all moldings and have a shiplap of at least 2". Flashing tape may be required over the upper attachment flange of trims running horizontally as an avenue for moisture to flow out from behind the system. Attach moldings 16" or 24" on center to the framing using approved fastening methods. Butt joints must be cut accurately and sealed.

PANEL TRIM ALLOY & COMPOSITION

Flannery's Panel Trims are standard extruded aluminum alloy 6063 T5 and have a typical .050" nominal wall thickness. Aluminum Panel Trims are aesthetic trims which are not intended to hold or support the weight of any panel system. Please consult a structural engineer when considering the use of Flannery Furring Strips or Z-Fur Strips in a rainscreen system.

INSTALLATION DETAILS

Panel Trims come in 10' lengths and shall have a standard Clear Anodized, Chem-Film Finish or Mill Finish (for field priming & painting). Custom anodizing, factory painting and polishing is available.

FACTORY FINISHES

MILL FINISH

"Mill Finish" is the term that Flannery uses to describe its aluminum trims that have no finish applied to them. In other words, it is raw aluminum from our mill and it can be field primed and painted. Typically, Mill Finish has a shiny or "mirror-like" appearance with some visible manufacturing lines.

Mill Finish trims must be cleaned before field priming occurs. Typically, soapy water should clean most oils or production residue from the surface of the trim. Sufficient drying time should be planned before primer is applied. The paint manufacturer should be consulted when choosing a primer for aluminum trims. Mill Finish trims should never be left exposed for an extended period of time, since this may allow the metal to begin the oxidation process. All aluminum trims must be covered with a proper paint or anodized finish.

CLEAR ANODIZED FINISH

The standard finish for Flannery's trims is a Clear Anodized Finish (Architectural 200R1). The Clear Anodized finish is an electrochemical conversion process that deposits an oxide film on the aluminum trim. A natural oxidation process occurs on bare aluminum, however producing the oxidation process artificially creates a thicker, harder, and more durable "oxide film." The Clear Anodized finish is an extremely durable finish and is resistant to most forms of corrosion.

Standard Clear Anodized Finish- Architectural 200R1 medium etch (AA-M32C10A21). Thickness of anodic coating shall be tested in accordance with ASTM B-244-68.

COLOR ANODIZING

Special Color Anodized finishes are also available if required. Gold Anodized, Black Anodized, and Bronze Anodized finishes can be ordered. Bronze Anodized can be ordered in three different color shades: Light, Medium, and Dark Bronze. Please note: Color Anodized Finishes can vary from one piece of trim to another. This is one of the characteristics to the anodizing process and must be considered before any orders are placed. Typically, the color of the anodizing will fall within a certain range, which usually can be determined prior to anodizing. Check with Flannery for details.

Color Anodized Finish- Two-step impregnated color Class II Architectural .40-.70 mils (AA-M12C22A33). Thickness of coating shall be tested in accordance with ASTM B244-68.

POLISHED ANODIZING

Flannery offers special "Brushed" or "Polished" anodized finishes that imitate finishes found on other types of metals including Stainless Steel, Brushed Stainless Steel, Brass and other metals. These types of anodized finishes require a sample of the desired finish to be submitted to Flannery for quotation and minimum order quantities may apply. Some smaller reveals may not be available with these special finishes due to production restrictions.

CHEMICAL CONVERSION COAT FINISH

Chem-film (aka Alodine) is a chemical conversion process that prepares aluminum extrusions for field painting. It is a multi-step cleaning and aluminum preparation process. First, it cleans the aluminum trim and then it acts as a protective coating until primer, then paint can be applied. If your job requires field painting, a chemical conversion coating can be specified.

Chem-film/Alodine- Treatment of aluminum moldings to conform to ASTM D 1730 Type B and MIL-C-5541A.

KYNAR® PAINT FINISH

Kynar® is a 70% fluoropolymer resin based 2-coat baked on paint that is offered by Flannery as an optional finish where high durability is needed or an existing color must be matched. Kynar® finishes are highly resistant to chalking and ultraviolet deterioration. They are also highly resistant to chemicals, salt spray, and industrial pollutants. Flannery recommends these finishes for trims on exteriors in harsh environments including coastal areas where salt air is most common. Kynar® paint finishes are available in custom colors. Please note that some finishes will require a Kynar® XL (with topcoat) finish due to the exotic nature of the color. Please have the color code or sample available when requesting a quote for these custom colors.

Kynar® Paint Finishes shall meet or exceed AAMA 605.2 Specification "Voluntary Specification for High Performance Organic Coatings on Architectural Extrusion Panels." Meets or exceeds a nominal dry film thickness of 1.2 mil. (Kynar® is a registered trademark of Atochem North America, Inc).

POWDER-COATED PAINT FINISHES

Flannery offers Powder-Coated Paint Finishes on all of its aluminum trims. Flannery's factory powder-coated paint process can match any paint manufacturer's paint number or match a custom paint color to provide the desired aesthetic finish. Powder-coated paint finishes are applied to the aluminum trims after a chem-film finish and factory primer has been applied. Please have the color code or sample available when requesting a quote for these custom colors.

Powder-Coated Paint finishes shall meet or exceed the dry film thickness of 1.2 mil as specified in AAMA 2605 SEC 4.3. Color uniformity will meet or exceed the requirements of AAMA 2605 SEC 7.1.

This brochure presents general guidelines and suggestions for the installation of Flannery trims and products. The purpose of these general guidelines and suggestions is to aid in a successful interior or exterior finish based on the Uniform Building Code and industry standards. No one catalog or brochure can address all of the unique specifics or installation details that occur from one project to another. Flannery recommends that every installer be familiar, or become acquainted with, common interior or exterior trim installation practices before installing any of Flannery's many trims and products. Flannery also recommends that the specifying architect, engineer, and general contractor be consulted with as well.





300 Parkside Drive
San Fernando, California 91340
flannerytrim.com - 818.837.7585



Flannery, Inc
Specialty Aluminum Trims



PANEL TRIMS